

www.souratigroup.com

Martha's Vineyard Office
107 Beach Rd., Suite 202
P.O. Box 4458, Vineyard Haven, MA 02568
Phone: 508-693-9933, Fax: 508-693-4933

Nantucket Office:
35 Old South Road, Nantucket, MA 02554
Phone: 508-228-7888, Fax: 508-228-5511

August 2, 2023

Chilmark Conservation Commission
P.O. Box 119
Chilmark, MA 02535

RE: **Steven Lofchie and Sarah Fox**
Map 26, Parcel 119
1 Old North Road
Chilmark, MA 02535
Construction of an addition

Dear Commission Members:

Please find enclosed an original and a copy of a Notice of Intent and its supporting documents for proposed work at the above referenced property. Also enclosed is the filing fee check (#21022) in the amount of \$67.50.

Supporting documents enclosed:

- Copy of WPA Appendix A Wetland Fee Transmittal Form
- Copy of filing fee checks to the Commonwealth of Massachusetts and the Town of Chilmark
- Notice to Abutters, Abutters List, Abutters Map and Affidavit of Service
- USGS Locus Map
- Site Plan in Chilmark, MA prepared for Steven Lofchie and Sarah Fox by Sourati Engineering Group LLC dated July 28, 2023

Please contact me if you have any questions.

Sincerely,

A handwritten signature in black ink, appearing to read "Bryan Collins", written over a white background.

Bryan Collins

Cc: DEP SERO

SEP 10 2023



Massachusetts Department of Environmental Protection
Bureau of Resource Protection - Wetlands

Provided by MassDEP:

WPA Form 3 – Notice of Intent

Massachusetts Wetlands Protection Act M.G.L. c. 131, §40
and the Chilmark Wetlands Protection Bylaws

MassDEP File Number
Document Transaction Number
Chilmark
City/Town

Important:
When filling out forms on the computer, use only the tab key to move your cursor - do not use the return key.

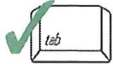

Note:
Before completing this form consult your local Conservation Commission regarding any municipal bylaw or ordinance.

A. General Information

1. Project Location (**Note:** electronic filers will click on button to locate project site):

1 Old North Road	Chilmark	02535
a. Street Address	b. City/Town	c. Zip Code
Latitude and Longitude:	41.350080	-70.742280
26	d. Latitude	e. Longitude
f. Assessors Map/Plat Number	119	g. Parcel /Lot Number

2. Applicant:

a. First Name	b. Last Name	
See attached additional information page.		
c. Organization		
d. Street Address		
e. City/Town	f. State	g. Zip Code
h. Phone Number	i. Fax Number	j. Email Address

3. Property owner (required if different from applicant): Check if more than one owner

a. First Name	b. Last Name	
c. Organization		
d. Street Address		
e. City/Town	f. State	g. Zip Code
h. Phone Number	i. Fax Number	j. Email address

4. Representative (if any):

George	Sourati	
a. First Name	b. Last Name	
Sourati Engineering Group LLC		
c. Company		
107 Beach Road, Suite 202		
d. Street Address		
Vineyard Haven	MA	02568
e. City/Town	f. State	g. Zip Code
(508) 693-9933	(508) 693-4933	gsourati@souratigroup.com
h. Phone Number	i. Fax Number	j. Email address

5. Total WPA Fee Paid (from NOI Wetland Fee Transmittal Form):

\$110.00	\$42.50	\$67.50
a. Total Fee Paid	b. State Fee Paid	c. City/Town Fee Paid

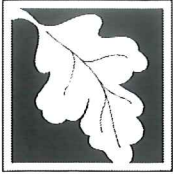

Massachusetts Department of Environmental Protection
Bureau of Resource Protection - Wetlands

Provided by MassDEP:

WPA Form 3 – Notice of Intent

Massachusetts Wetlands Protection Act M.G.L. c. 131, §40

MassDEP File Number

Document Transaction Number

Chilmark

City/Town

A. General Information (continued)

6. General Project Description:

The project consists of the construction of a 10'x12' addition to an existing guest house located 82'± from a 789± S.F. Isolated Wetland.

7a. Project Type Checklist: (Limited Project Types see Section A. 7b.)

- | | |
|---|---|
| 1. <input checked="" type="checkbox"/> Single Family Home | 2. <input type="checkbox"/> Residential Subdivision |
| 3. <input type="checkbox"/> Commercial/Industrial | 4. <input type="checkbox"/> Dock/Pier |
| 5. <input type="checkbox"/> Utilities | 6. <input type="checkbox"/> Coastal engineering Structure |
| 7. <input type="checkbox"/> Agriculture (e.g., cranberries, forestry) | 8. <input type="checkbox"/> Transportation |
| 9. <input type="checkbox"/> Other | |

7b. Is any portion of the proposed activity eligible to be treated as a limited project (including Ecological Restoration Limited Project) subject to 310 CMR 10.24 (coastal) or 310 CMR 10.53 (inland)?

1. Yes No If yes, describe which limited project applies to this project. (See 310 CMR 10.24 and 10.53 for a complete list and description of limited project types)

2. Limited Project Type

If the proposed activity is eligible to be treated as an Ecological Restoration Limited Project (310 CMR 10.24(8), 310 CMR 10.53(4)), complete and attach Appendix A: Ecological Restoration Limited Project Checklist and Signed Certification.

8. Property recorded at the Registry of Deeds for:

Dukes

a. County

1649

c. Book

b. Certificate # (if registered land)

591

d. Page Number

B. Buffer Zone & Resource Area Impacts (temporary & permanent)

- Buffer Zone Only – Check if the project is located only in the Buffer Zone of a Bordering Vegetated Wetland, Inland Bank, or Coastal Resource Area.
- Inland Resource Areas (see 310 CMR 10.54-10.58; if not applicable, go to Section B.3, Coastal Resource Areas).

Check all that apply below. Attach narrative and any supporting documentation describing how the project will meet all performance standards for each of the resource areas altered, including standards requiring consideration of alternative project design or location.



Massachusetts Department of Environmental Protection
Bureau of Resource Protection - Wetlands

WPA Form 3 – Notice of Intent

Massachusetts Wetlands Protection Act M.G.L. c. 131, §40

Provided by MassDEP:

MassDEP File Number

Document Transaction Number

Chilmark

City/Town

B. Buffer Zone & Resource Area Impacts (temporary & permanent) (cont'd)

For all projects affecting other Resource Areas, please attach a narrative explaining how the resource area was delineated.

Resource Area	Size of Proposed Alteration	Proposed Replacement (if any)
a. <input type="checkbox"/> Bank	1. linear feet	2. linear feet
b. <input type="checkbox"/> Bordering Vegetated Wetland	1. square feet	2. square feet
c. <input type="checkbox"/> Land Under Waterbodies and Waterways	1. square feet	2. square feet
	3. cubic yards dredged	

Resource Area	Size of Proposed Alteration	Proposed Replacement (if any)
d. <input type="checkbox"/> Bordering Land Subject to Flooding	1. square feet	2. square feet
	3. cubic feet of flood storage lost	4. cubic feet replaced
e. <input type="checkbox"/> Isolated Land Subject to Flooding	1. square feet	
	2. cubic feet of flood storage lost	3. cubic feet replaced

- f. Riverfront Area
1. Name of Waterway (if available) - **specify coastal or inland**
 2. Width of Riverfront Area (check one):
 - 25 ft. - Designated Densely Developed Areas only
 - 100 ft. - New agricultural projects only
 - 200 ft. - All other projects

3. Total area of Riverfront Area on the site of the proposed project: _____ square feet

4. Proposed alteration of the Riverfront Area:

a. total square feet b. square feet within 100 ft. c. square feet between 100 ft. and 200 ft.

5. Has an alternatives analysis been done and is it attached to this NOI? Yes No

6. Was the lot where the activity is proposed created prior to August 1, 1996? Yes No

3. Coastal Resource Areas: (See 310 CMR 10.25-10.35)

Note: for coastal riverfront areas, please complete **Section B.2.f.** above.



Massachusetts Department of Environmental Protection
 Bureau of Resource Protection - Wetlands

Provided by MassDEP:

WPA Form 3 – Notice of Intent

Massachusetts Wetlands Protection Act M.G.L. c. 131, §40

MassDEP File Number _____

Document Transaction Number _____

Chilmark _____

City/Town _____

B. Buffer Zone & Resource Area Impacts (temporary & permanent) (cont'd)

Check all that apply below. Attach narrative and supporting documentation describing how the project will meet all performance standards for each of the resource areas altered, including standards requiring consideration of alternative project design or location.

Online Users:
 Include your document transaction number (provided on your receipt page) with all supplementary information you submit to the Department.

<u>Resource Area</u>	<u>Size of Proposed Alteration</u>	<u>Proposed Replacement (if any)</u>
a. <input type="checkbox"/> Designated Port Areas	Indicate size under Land Under the Ocean, below	
b. <input type="checkbox"/> Land Under the Ocean	_____	1. square feet
	_____	2. cubic yards dredged
c. <input type="checkbox"/> Barrier Beach	Indicate size under Coastal Beaches and/or Coastal Dunes below	
d. <input type="checkbox"/> Coastal Beaches	_____	1. square feet
	_____	2. cubic yards beach nourishment
e. <input type="checkbox"/> Coastal Dunes	_____	1. square feet
	_____	2. cubic yards dune nourishment

	<u>Size of Proposed Alteration</u>	<u>Proposed Replacement (if any)</u>
f. <input type="checkbox"/> Coastal Banks	_____	1. linear feet
g. <input type="checkbox"/> Rocky Intertidal Shores	_____	1. square feet
h. <input type="checkbox"/> Salt Marshes	_____	1. square feet
	_____	2. sq ft restoration, rehab., creation
i. <input type="checkbox"/> Land Under Salt Ponds	_____	1. square feet
	_____	2. cubic yards dredged
	_____	1. square feet
j. <input type="checkbox"/> Land Containing Shellfish	_____	1. square feet
	_____	1. square feet
k. <input type="checkbox"/> Fish Runs	Indicate size under Coastal Banks, inland Bank, Land Under the Ocean, and/or inland Land Under Waterbodies and Waterways, above	
	_____	1. cubic yards dredged
	_____	1. square feet

4. Restoration/Enhancement
 If the project is for the purpose of restoring or enhancing a wetland resource area in addition to the square footage that has been entered in Section B.2.b or B.3.h above, please enter the additional amount here.

a. square feet of BVW

b. square feet of Salt Marsh

5. Project Involves Stream Crossings

a. number of new stream crossings

b. number of replacement stream crossings



Massachusetts Department of Environmental Protection
Bureau of Resource Protection - Wetlands

WPA Form 3 – Notice of Intent

Massachusetts Wetlands Protection Act M.G.L. c. 131, §40

Provided by MassDEP:

MassDEP File Number _____

Document Transaction Number _____

Chilmark _____

City/Town _____

C. Other Applicable Standards and Requirements

- This is a proposal for an Ecological Restoration Limited Project. Skip Section C and complete Appendix A: Ecological Restoration Limited Project Checklists – Required Actions (310 CMR 10.11).

Streamlined Massachusetts Endangered Species Act/Wetlands Protection Act Review

1. Is any portion of the proposed project located in **Estimated Habitat of Rare Wildlife** as indicated on the most recent Estimated Habitat Map of State-Listed Rare Wetland Wildlife published by the Natural Heritage and Endangered Species Program (NHESP)? To view habitat maps, see the *Massachusetts Natural Heritage Atlas* or go to http://maps.massgis.state.ma.us/PRI_EST_HAB/viewer.htm.

- a. Yes No **If yes, include proof of mailing or hand delivery of NOI to:**

Natural Heritage and Endangered Species Program
Division of Fisheries and Wildlife
1 Rabbit Hill Road
Westborough, MA 01581

8/1/2021

b. Date of map

If yes, the project is also subject to Massachusetts Endangered Species Act (MESA) review (321 CMR 10.18). To qualify for a streamlined, 30-day, MESA/Wetlands Protection Act review, please complete Section C.1.c, and include requested materials with this Notice of Intent (NOI); *OR* complete Section C.2.f, if applicable. *If MESA supplemental information is not included with the NOI, by completing Section 1 of this form, the NHESP will require a separate MESA filing which may take up to 90 days to review (unless noted exceptions in Section 2 apply, see below).*

- c. Submit Supplemental Information for Endangered Species Review*

1. Percentage/acreage of property to be altered:

(a) within wetland Resource Area

_____ percentage/acreage

(b) outside Resource Area

_____ percentage/acreage

2. Assessor's Map or right-of-way plan of site

2. Project plans for entire project site, including wetland resource areas and areas outside of wetlands jurisdiction, showing existing and proposed conditions, existing and proposed tree/vegetation clearing line, and clearly demarcated limits of work **

(a) Project description (including description of impacts outside of wetland resource area & buffer zone)

(b) Photographs representative of the site

* Some projects **not** in Estimated Habitat may be located in Priority Habitat, and require NHESP review (see <http://www.mass.gov/eea/agencies/dfg/dfw/natural-heritage/regulatory-review/>). Priority Habitat includes habitat for state-listed plants and strictly upland species not protected by the Wetlands Protection Act.

** MESA projects may not be segmented (321 CMR 10.16). The applicant must disclose full development plans even if such plans are not required as part of the Notice of Intent process.

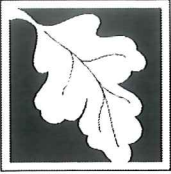

Massachusetts Department of Environmental Protection
Bureau of Resource Protection - Wetlands

WPA Form 3 – Notice of Intent

Massachusetts Wetlands Protection Act M.G.L. c. 131, §40

Provided by MassDEP:

MassDEP File Number

Document Transaction Number

Chilmark

City/Town

C. Other Applicable Standards and Requirements (cont'd)

- (c) MESA filing fee (fee information available at http://www.mass.gov/dfwele/dfw/nhosp/regulatory_review/ mesa/ mesa_fee_schedule.htm). Make check payable to "Commonwealth of Massachusetts - NHESP" and **mail to NHESP** at above address

Projects altering 10 or more acres of land, also submit:

- (d) Vegetation cover type map of site

- (e) Project plans showing Priority & Estimated Habitat boundaries

- (f) OR Check One of the Following

1. Project is exempt from MESA review.
Attach applicant letter indicating which MESA exemption applies. (See 321 CMR 10.14, http://www.mass.gov/dfwele/dfw/nhosp/regulatory_review/ mesa/ mesa_exemptions.htm; the NOI must still be sent to NHESP if the project is within estimated habitat pursuant to 310 CMR 10.37 and 10.59.)

2. Separate MESA review ongoing. a. NHESP Tracking # _____ b. Date submitted to NHESP _____

3. Separate MESA review completed.
Include copy of NHESP "no Take" determination or valid Conservation & Management Permit with approved plan.

3. For coastal projects only, is any portion of the proposed project located below the mean high water line or in a fish run?

- a. Not applicable – project is in inland resource area only b. Yes No

If yes, include proof of mailing, hand delivery, or electronic delivery of NOI to either:

South Shore - Cohasset to Rhode Island border, and the Cape & Islands:

Division of Marine Fisheries -
Southeast Marine Fisheries Station
Attn: Environmental Reviewer
836 South Rodney French Blvd.
New Bedford, MA 02744
Email: DMF.EnvReview-South@state.ma.us

North Shore - Hull to New Hampshire border:

Division of Marine Fisheries -
North Shore Office
Attn: Environmental Reviewer
30 Emerson Avenue
Gloucester, MA 01930
Email: DMF.EnvReview-North@state.ma.us

Also if yes, the project may require a Chapter 91 license. For coastal towns in the Northeast Region, please contact MassDEP's Boston Office. For coastal towns in the Southeast Region, please contact MassDEP's Southeast Regional Office.

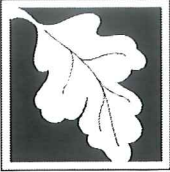

Massachusetts Department of Environmental Protection
Bureau of Resource Protection - Wetlands

WPA Form 3 – Notice of Intent

Massachusetts Wetlands Protection Act M.G.L. c. 131, §40

Provided by MassDEP:

MassDEP File Number

Document Transaction Number

Chilmark

City/Town

C. Other Applicable Standards and Requirements (cont'd)

Online Users:
Include your document transaction number (provided on your receipt page) with all supplementary information you submit to the Department.

4. Is any portion of the proposed project within an Area of Critical Environmental Concern (ACEC)?
- a. Yes No If yes, provide name of ACEC (see instructions to WPA Form 3 or MassDEP Website for ACEC locations). **Note:** electronic filers click on Website.
- b. ACEC
5. Is any portion of the proposed project within an area designated as an Outstanding Resource Water (ORW) as designated in the Massachusetts Surface Water Quality Standards, 314 CMR 4.00?
- a. Yes No
6. Is any portion of the site subject to a Wetlands Restriction Order under the Inland Wetlands Restriction Act (M.G.L. c. 131, § 40A) or the Coastal Wetlands Restriction Act (M.G.L. c. 130, § 105)?
- a. Yes No
7. Is this project subject to provisions of the MassDEP Stormwater Management Standards?
- a. Yes. Attach a copy of the Stormwater Report as required by the Stormwater Management Standards per 310 CMR 10.05(6)(k)-(q) and check if:
1. Applying for Low Impact Development (LID) site design credits (as described in Stormwater Management Handbook Vol. 2, Chapter 3)
 2. A portion of the site constitutes redevelopment
 3. Proprietary BMPs are included in the Stormwater Management System.
- b. No. Check why the project is exempt:
1. Single-family house
 2. Emergency road repair
 3. Small Residential Subdivision (less than or equal to 4 single-family houses or less than or equal to 4 units in multi-family housing project) with no discharge to Critical Areas.

D. Additional Information

- This is a proposal for an Ecological Restoration Limited Project. Skip Section D and complete Appendix A: Ecological Restoration Notice of Intent – Minimum Required Documents (310 CMR 10.12).

Applicants must include the following with this Notice of Intent (NOI). See instructions for details.

Online Users: Attach the document transaction number (provided on your receipt page) for any of the following information you submit to the Department.

1. USGS or other map of the area (along with a narrative description, if necessary) containing sufficient information for the Conservation Commission and the Department to locate the site. (Electronic filers may omit this item.)
2. Plans identifying the location of proposed activities (including activities proposed to serve as a Bordering Vegetated Wetland [BVW] replication area or other mitigating measure) relative to the boundaries of each affected resource area.



Massachusetts Department of Environmental Protection
Bureau of Resource Protection - Wetlands

WPA Form 3 – Notice of Intent

Massachusetts Wetlands Protection Act M.G.L. c. 131, §40

Provided by MassDEP:

MassDEP File Number

Document Transaction Number

Chilmark

City/Town

D. Additional Information (cont'd)

3. Identify the method for BVW and other resource area boundary delineations (MassDEP BVW Field Data Form(s), Determination of Applicability, Order of Resource Area Delineation, etc.), and attach documentation of the methodology.

4. List the titles and dates for all plans and other materials submitted with this NOI.

Site Plan

a. Plan Title

Sourati Engineering Group LLC

Charles R. Gilstad, P.L.S.

b. Prepared By

c. Signed and Stamped by

July 28, 2023

1" = 30'

d. Final Revision Date

e. Scale

f. Additional Plan or Document Title

g. Date

5. If there is more than one property owner, please attach a list of these property owners not listed on this form.

6. Attach proof of mailing for Natural Heritage and Endangered Species Program, if needed.

7. Attach proof of mailing for Massachusetts Division of Marine Fisheries, if needed.

8. Attach NOI Wetland Fee Transmittal Form

9. Attach Stormwater Report, if needed.

E. Fees

1. Fee Exempt: No filing fee shall be assessed for projects of any city, town, county, or district of the Commonwealth, federally recognized Indian tribe housing authority, municipal housing authority, or the Massachusetts Bay Transportation Authority.

Applicants must submit the following information (in addition to pages 1 and 2 of the NOI Wetland Fee Transmittal Form) to confirm fee payment:

21022

2. Municipal Check Number

8/2/2023

3. Check date

21023

4. State Check Number

8/2/2023

5. Check date

Sourati Engineering Group LLC

6. Payor name on check: First Name

Sourati

7. Payor name on check: Last Name

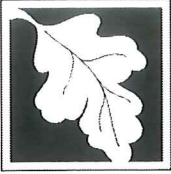

Massachusetts Department of Environmental Protection
Bureau of Resource Protection - Wetlands

WPA Form 3 – Notice of Intent

Massachusetts Wetlands Protection Act M.G.L. c. 131, §40

Provided by MassDEP:

MassDEP File Number

Document Transaction Number

Chilmark

City/Town

F. Signatures and Submittal Requirements

I hereby certify under the penalties of perjury that the foregoing Notice of Intent and accompanying plans, documents, and supporting data are true and complete to the best of my knowledge. I understand that the Conservation Commission will place notification of this Notice in a local newspaper at the expense of the applicant in accordance with the wetlands regulations, 310 CMR 10.05(5)(a).

I further certify under penalties of perjury that all abutters were notified of this application, pursuant to the requirements of M.G.L. c. 131, § 40. Notice must be made by Certificate of Mailing or in writing by hand delivery or certified mail (return receipt requested) to all abutters within 100 feet of the property line of the project location.

1. Signature of Applicant

2. Date

3. Signature of Property Owner (if different)

4. Date

George Socrate Representative

8/21/2023

5. Signature of Representative (if any)

6. Date

For Conservation Commission:

Two copies of the completed Notice of Intent (Form 3), including supporting plans and documents, two copies of the NOI Wetland Fee Transmittal Form, and the city/town fee payment, to the Conservation Commission by certified mail or hand delivery.

For MassDEP:

One copy of the completed Notice of Intent (Form 3), including supporting plans and documents, one copy of the NOI Wetland Fee Transmittal Form, and a **copy** of the state fee payment to the MassDEP Regional Office (see Instructions) by certified mail or hand delivery.

Other:

If the applicant has checked the "yes" box in any part of Section C, Item 3, above, refer to that section and the Instructions for additional submittal requirements.

The original and copies must be sent simultaneously. Failure by the applicant to send copies in a timely manner may result in dismissal of the Notice of Intent.

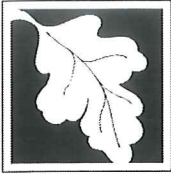

Massachusetts Department of Environmental Protection
 Bureau of Resource Protection - Wetlands
NOI Wetland Fee Transmittal Form
 Massachusetts Wetlands Protection Act M.G.L. c. 131, §40

Important: When filling out forms on the computer, use only the tab key to move your cursor - do not use the return key.

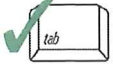

A. Applicant Information

1. Location of Project:

<u>1 Old North Road</u>	<u>Chilmark</u>
a. Street Address	b. City/Town
<u>21023</u>	<u>\$42.5</u>
c. Check number	d. Fee amount

2. Applicant Mailing Address:

<u>Steven Lofchie and Sarah Fox</u>	<u>c/o Sourati Engineering Group LLC</u>	
c. Organization		
<u>P.O. Box 4458</u>		
d. Mailing Address		
<u>Vineyard Haven</u>	<u>MA</u>	<u>02568</u>
e. City/Town	f. State	g. Zip Code
<u>508-693-9933</u>	<u>508-693-4933</u>	<u>gsourati@souratigroup.com</u>
h. Phone Number	i. Fax Number	j. Email Address

3. Property Owner (if different):

<u></u>	<u></u>	
a. First Name	b. Last Name	
<u></u>		
c. Organization		
<u></u>		
d. Mailing Address		
<u></u>	<u></u>	<u></u>
e. City/Town	f. State	g. Zip Code
<u></u>	<u></u>	<u></u>
h. Phone Number	i. Fax Number	j. Email Address

B. Fees

Fee should be calculated using the following process & worksheet. ***Please see Instructions before filling out worksheet.***

Step 1/Type of Activity: Describe each type of activity that will occur in wetland resource area and buffer zone.

Step 2/Number of Activities: Identify the number of each type of activity.

Step 3/Individual Activity Fee: Identify each activity fee from the six project categories listed in the instructions.

Step 4/Subtotal Activity Fee: Multiply the number of activities (identified in Step 2) times the fee per category (identified in Step 3) to reach a subtotal fee amount. Note: If any of these activities are in a Riverfront Area in addition to another Resource Area or the Buffer Zone, the fee per activity should be multiplied by 1.5 and then added to the subtotal amount.

Step 5/Total Project Fee: Determine the total project fee by adding the subtotal amounts from Step 4.

Step 6/Fee Payments: To calculate the state share of the fee, divide the total fee in half and subtract \$12.50. To calculate the city/town share of the fee, divide the total fee in half and add \$12.50.

To calculate filing fees, refer to the category fee list and examples in the instructions for filling out WPA Form 3 (Notice of Intent).

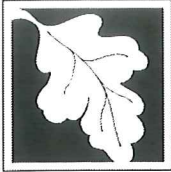

Massachusetts Department of Environmental Protection
 Bureau of Resource Protection - Wetlands
NOI Wetland Fee Transmittal Form
 Massachusetts Wetlands Protection Act M.G.L. c. 131, §40

B. Fees (continued)

Step 1/Type of Activity	Step 2/Number of Activities	Step 3/Individual Activity Fee	Step 4/Subtotal Activity Fee
Category 1 (addition)	1	\$110	\$110

Step 5/Total Project Fee: \$110.00

Step 6/Fee Payments:

Total Project Fee:	<u>\$110.00</u>
State share of filing Fee:	a. Total Fee from Step 5 <u>\$42.50</u>
City/Town share of filling Fee:	b. 1/2 Total Fee less \$12.50 <u>\$67.50</u>
	c. 1/2 Total Fee plus \$12.50

C. Submittal Requirements

- a.) Complete pages 1 and 2 and send with a check or money order for the state share of the fee, payable to the Commonwealth of Massachusetts.

Department of Environmental Protection
 Box 4062
 Boston, MA 02211

- b.) **To the Conservation Commission:** Send the Notice of Intent or Abbreviated Notice of Intent; a **copy** of this form; and the city/town fee payment.

To MassDEP Regional Office (see Instructions): Send a copy of the Notice of Intent or Abbreviated Notice of Intent; a **copy** of this form; and a **copy** of the state fee payment. (E-filers of Notices of Intent may submit these electronically.)

DEP File Number:

Provided by DEP

CHILMARK
Town

A. General Information

2. Applicants

	Applicant 1	Applicant 2
a. First Name	Steven	Sarah
b. Last Name	Lofchie	Fox
d. Street Address	115 West 86 th Street	
e. City/Town	New York	
f. State	NY	
g. Zip Code	10024	

D. Additional Information

1. USGS Locus Map
3. **Identify the method for BVW and other resource area boundary delineations and attach documentation of the methodology.**

The resource area boundary delineation was determined using the three-parameter method that incorporates topography, vegetation and soils.



www.souratigroup.com

Martha's Vineyard Office
107 Beach Rd., Suite 202
P.O. Box 4458, Vineyard Haven, MA 02568
Phone: 508-693-9933, Fax: 508-693-4933

Nantucket Office:
35 Old South Road, Nantucket, MA 02554
Phone: 508-228-7888, Fax: 508-228-5511

August 2, 2023

**Notification to Abutters Under the
Massachusetts Wetlands Protection Act and the
Town of Chilmark Wetlands Protection Bylaws**

Name of Applicants: **Steven Lofchie and Sarah Fox**

Dear Abutter,

In accordance with the second paragraph of the Massachusetts General Laws Chapter 131, Sec. 40, you are hereby notified of the following:

The applicants have filed a Notice of Intent with the Chilmark Conservation Commission seeking to perform the following work: **The project consists of the construction of a 10'x12' addition to an existing guest house located 82'± from a 789± S.F. Isolated Wetland.**

The work is subject to protection under the Wetlands Protection Act (General Laws Chapter 131, Section 40) and the Town of Chilmark Wetlands Protection Bylaws.

The address of the lot where the activity is proposed is:

1 Old North Road, Assessor's Map 26, Parcel 119, Chilmark, MA

Notice of the public meeting/hearing, including the date, time and place will be published at least five days in advance in the Vineyard Gazette or the Martha's Vineyard Times, and will be posted in the Chilmark Town Hall no less than forty-eight (48) hours in advance.

Copies of the application can be examined and information about the date, time and place of the meeting/hearing can be obtained from either the Chilmark Conservation Commission office, Chilmark Town Hall, Tuesday and Thursday, 9:00 a.m. to 5:00 p.m. (508-645-2104) or copies of the application may be viewed at Sourati Engineering Group, LLC, 107 Beach Road, Suite 202, Vineyard Haven, MA 02568, (508-693-9933).

You may also contact the Department of Environmental Protection for more information about this application or the Wetlands Protection Act: 508-946-2800.

Sincerely,

A handwritten signature in black ink, appearing to read "Bryan Collins", written over a light blue horizontal line.

Bryan Collins



300 foot Abutters List Report

Chilmark, MA
August 02, 2023

Subject Property:

Parcel Number: 026-119-00
CAMA Number: 026-119-00
Property Address: 1 OLD NORTH RD

Mailing Address: LOFCHIE STEVEN & SARAH FOX
43 WEST 95TH ST
NEW YORK, NY 10025

Abutters:

Parcel Number: 026-066-01
CAMA Number: 026-066-01
Property Address: 12 OLD NORTH RD

Mailing Address: FLANDERS FRANCES TRUSTEE
THORPE ROBERT&J
GREENLANDS NOMINEE TRUST PO BOX
59
CHILMARK, MA 02535

Parcel Number: 026-066-03
CAMA Number: 026-066-03
Property Address: 14 WILLIAMS WAY

Mailing Address: SEXTON DONALD S III & ILIANA PARDO
PO BOX 291
CHILMARK, MA 02535-0291

Parcel Number: 026-066-04
CAMA Number: 026-066-04
Property Address: 47 HIGH MARK

Mailing Address: HANNEMANN ROBERT J & MARGARET L
47 HIGH MARK
CHILMARK, MA 02535

Parcel Number: 026-067-01
CAMA Number: 026-067-01
Property Address: 0 HIGH MARK

Mailing Address: LILAMVHM LLC
155 SEAPORT BLVD STE# 500
BOSTON, MA 01886

Parcel Number: 026-081-00
CAMA Number: 026-081-00
Property Address: 42 HIGH MARK

Mailing Address: KANE MICHAEL TRUSTEE
CPKB NOMINEE TRUST 39 PROSPECT
HILLS DRIVE
EAST LONGMEADOW, MA 01028

Parcel Number: 026-082-00
CAMA Number: 026-082-00
Property Address: 56 HIGH MARK

Mailing Address: DANFORTH STEPHANIE Y TRUSTEE
56 HIGHMARK RD RE TRUST PO BOX
454
CHILMARK, MA 02535

Parcel Number: 026-116-00
CAMA Number: 026-116-00
Property Address: 47 HIGH MARK

Mailing Address: HANNEMANN ROBERT J & MARGARET L
47 HIGH MARK
CHILMARK, MA 02535

Parcel Number: 026-120-00
CAMA Number: 026-120-00
Property Address: 20 MENEMSHA GATE

Mailing Address: BIERSTEDT ROBIN & PETER TRSTEEES
ET AL
MACIVER REALTY TRUST 832
BROADWAY APT# 8
NEW YORK, NY 10003

Parcel Number: 026-121-00
CAMA Number: 026-121-00
Property Address: 4 OLD NORTH RD

Mailing Address: GRAHAM SALLY J TRUSTEE
SJ GRAHAM TRUST 2017 PO BOX 587
CHILMARK, MA 02535



www.cai-tech.com

Data shown on this report is provided for planning and informational purposes only. The municipality and CAI Technologies are not responsible for any use for other purposes or misuse or misrepresentation of this report.

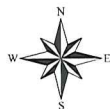

102731 300' Abutter Map, 1 Old North Road, Map 26

Chilmark, MA



August 2, 2023

1 inch = 400 Feet

www.cai-tech.com

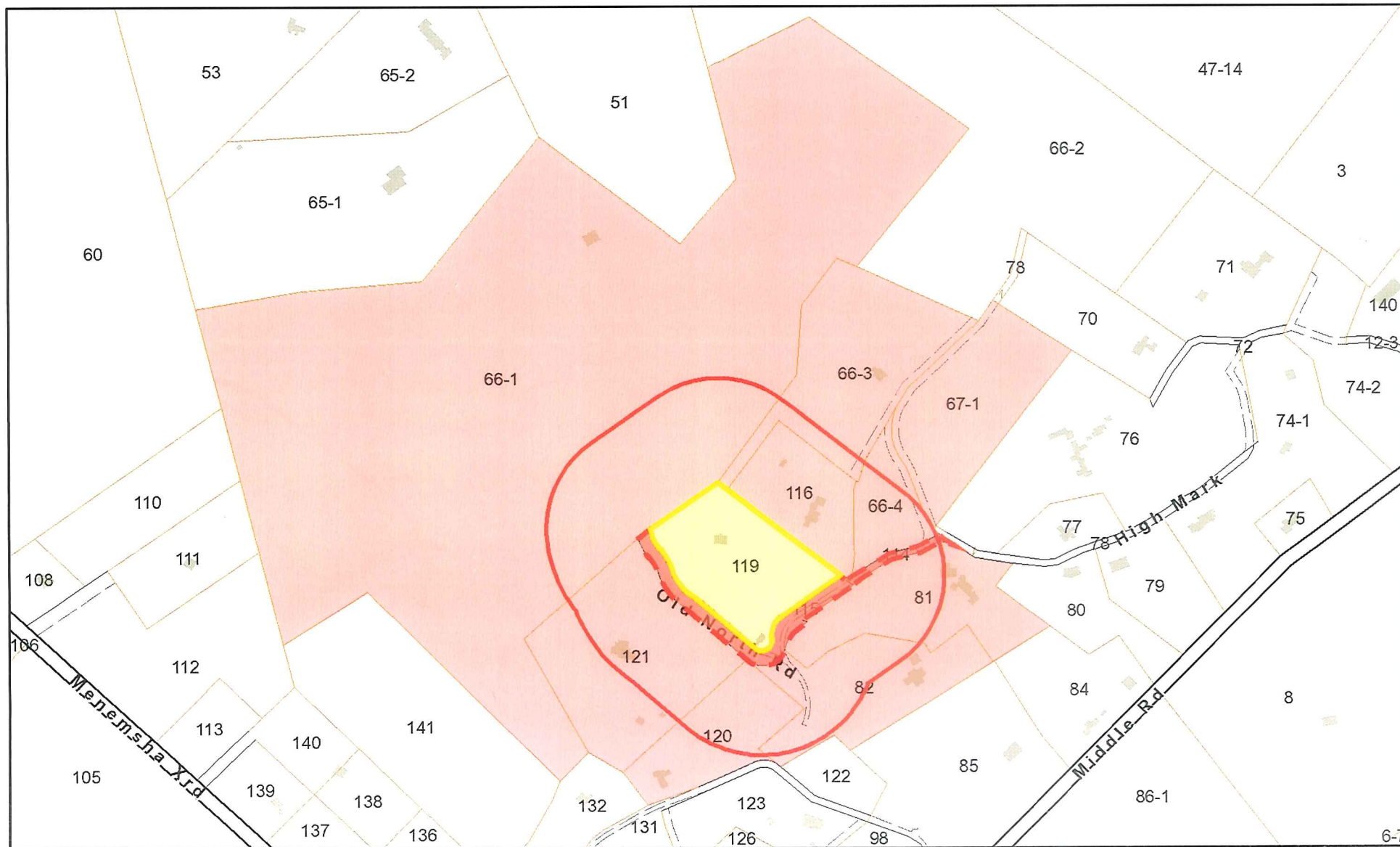

Data shown on this map is provided for planning and informational purposes only. The municipality and CAI Technologies are not responsible for any use for other purposes or misuse or misrepresentation of this map.

AFFIDAVIT OF SERVICE

Under the Massachusetts Wetlands Protection Act
And the Town of Chilmark Wetlands Protection Bylaws

I, Bryan Collins, hereby certify under the pains and penalties of perjury that to the best of my knowledge I gave notification to abutters in compliance with the second paragraph of Massachusetts General Laws Chapter 131, Section 40, and the DEP Guide to Abutter Notification dated April 9, 1994, in connection with the following matter:

A Notice of Intent filed under the Wetlands Protection Act and the Town of Chilmark Wetlands Protection Bylaws by Steven Lofchie and Sarah Fox with the Chilmark Conservation Commission for work at the property located at 1 Old North Road, Assessor's Map 26, Parcel 119, Chilmark, Massachusetts.

The form of notification, and a certified list of the abutters to whom it was given and their addresses, are attached to this Affidavit of Service.



Bryan Collins
Sourati Engineering Group, LLC

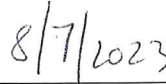

Date



U.S. DEPARTMENT OF THE INTERIOR
U.S. GEOLOGICAL SURVEY



TISBURY GREAT POND QUADRANGLE
MASSACHUSETTS - DUKE COUNTY
7.5-MINUTE SERIES

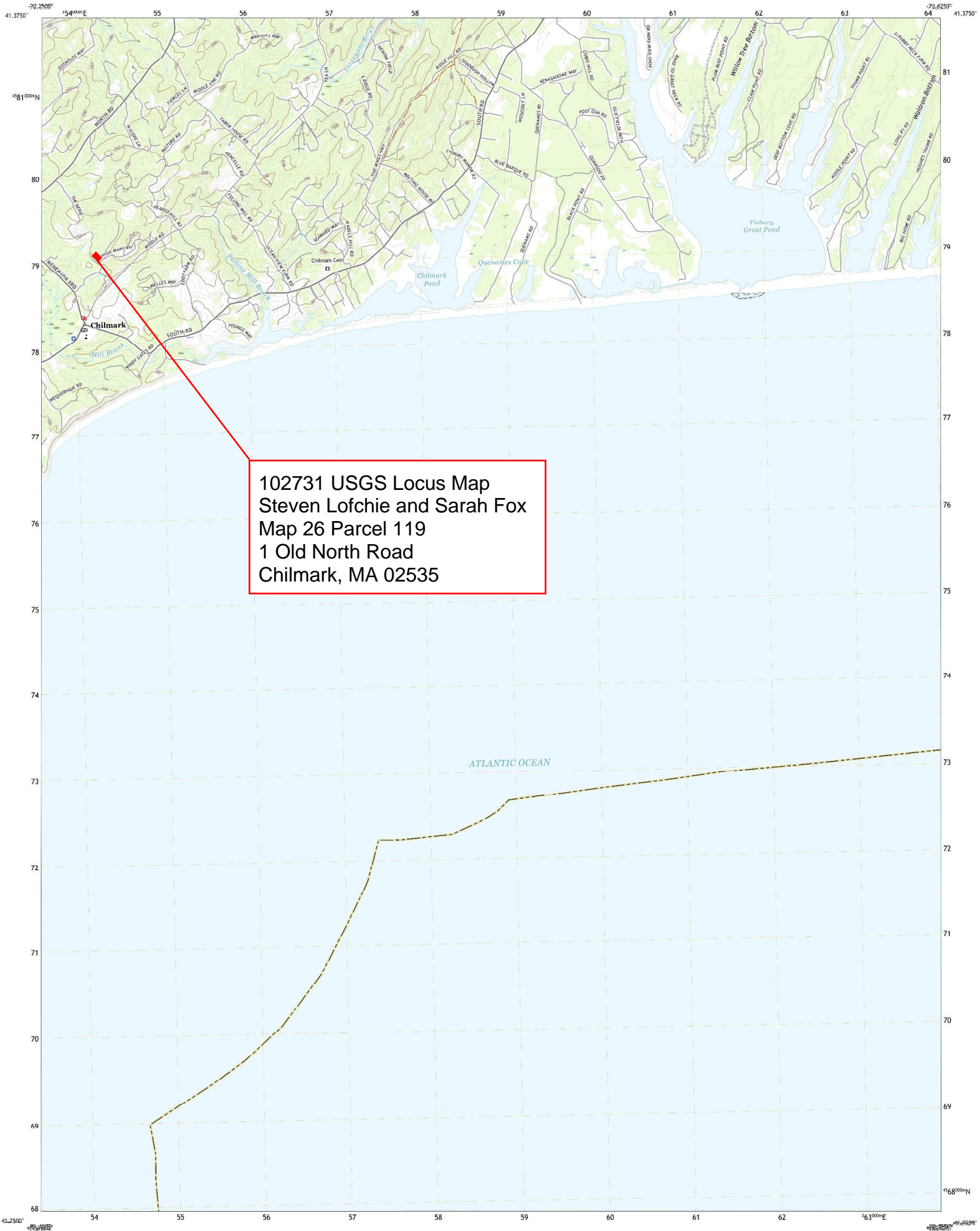

Produced by the United States Geological Survey
North American Datum of 1983 (NAD83)
World Geodetic System of 1984 (WGS84). Projection and 1 000-meter grid (Universal Transverse Mercator, Zone 19T)
This map is not a legal document. Boundaries may be generalized for this map scale. Private lands within government reservations may not be shown. Obtain permission before entering private lands.

Imagery.....MAP, August 2018
Roads.....U.S. Census Bureau, 2018
Hydrography.....National Hydrography Dataset, 1899 - 2019
Contours.....National Elevation Dataset, 2019
Boundaries.....Multiple sources; see metadata file 2018 - 2019
Wetlands.....FWS National Wetlands Inventory 2008 - 2011

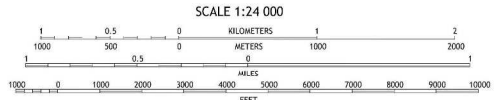
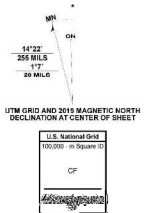

CONTOUR INTERVAL 10 FEET
NORTH AMERICAN VERTICAL DATUM OF 1988
This map was produced to conform with the National Geospatial Program US Topo Product Standard.



1	2	3	1 Newbury Island
4	5	6	2 Vineyard Haven
			3 Edgartown
			4 Squibnocket
			5 Edgartown DE 3
			6 Squibnocket DE 5

ROAD CLASSIFICATION

Expressway	Local Connector
Secondary Hwy	Local Road
Ramp	4WD
Interstate Route	UK Route
	State Route

TISBURY GREAT POND, MA



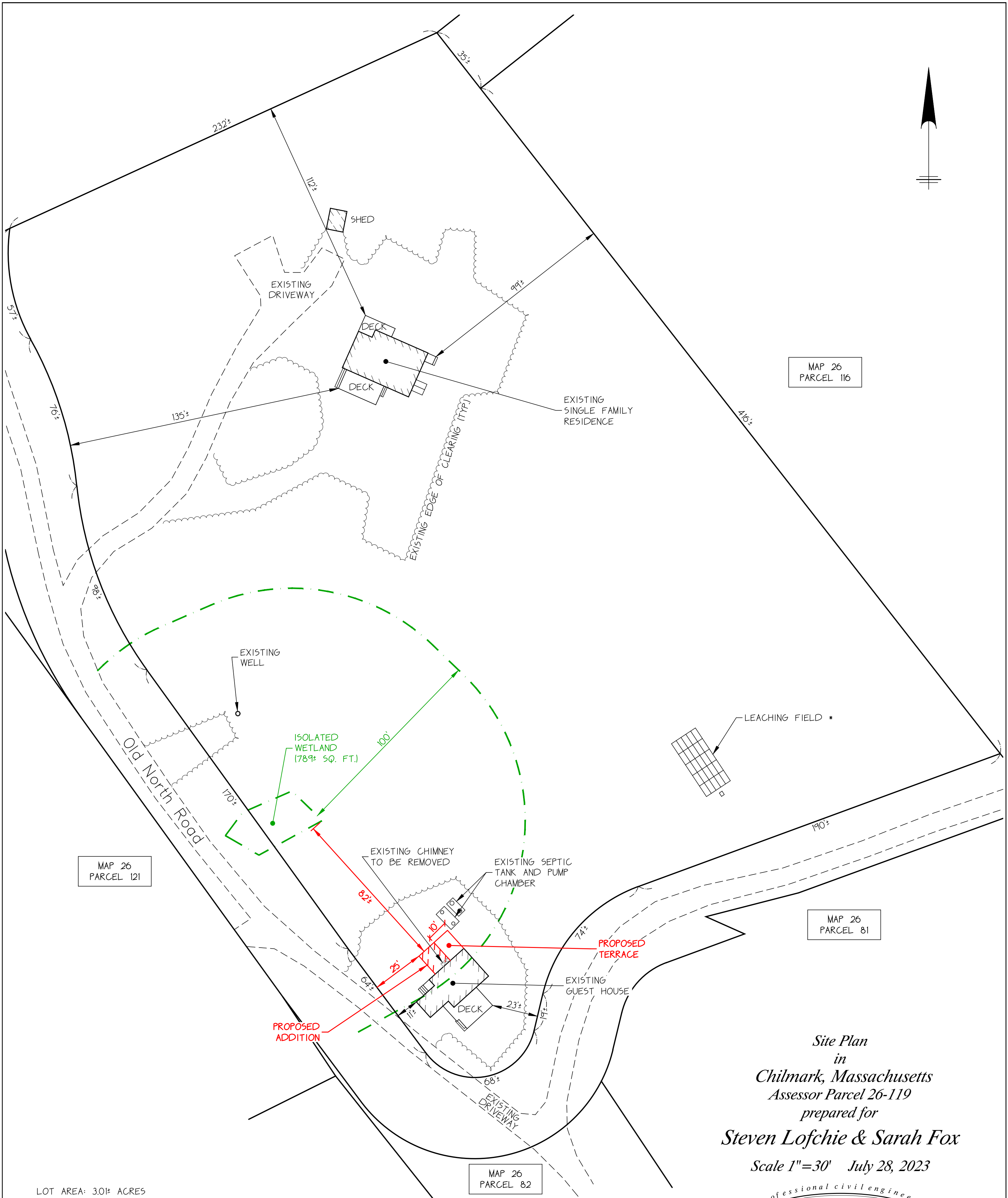
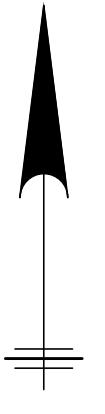

MAP 26
PARCEL 116

MAP 26
PARCEL 121

MAP 26
PARCEL 81

MAP 26
PARCEL 82

LOT AREA: 3.01± ACRES

* LOCATIONS TAKEN FROM SEPTIC PLAN
DATED JANUARY 30, 2023 ON RECORD AT
CHILMARK BOARD OF HEALTH.

Site Plan
in
Chilmark, Massachusetts
Assessor Parcel 26-119
prepared for
Steven Lofchie & Sarah Fox

Scale 1"=30' July 28, 2023

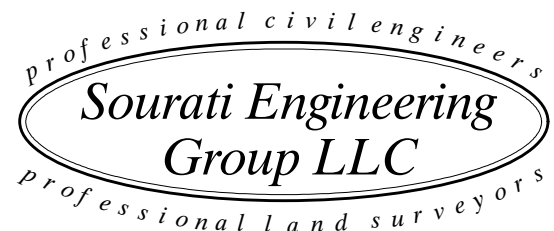

P.O. Box 4458
107 Beach Road, Suite 202
Vineyard Haven, MA 02568
Phone (508) 693-9933 Fax (508) 693-4933



Charles R. Gilstad
7/28/23