

WILKINSON

ECOLOGICAL DESIGN

28 LOTS HOLLOW RD., ORLEANS, MA 02653
 TEL: (508) 255-1113 FAX: (508) 255-9477
 WWW.WILKINSONECOLOGICAL.COM

THIS DRAWING AND ALL IDEAS EMBODIED THEREIN IS PROPRIETARY INFORMATION OF WILKINSON ECOLOGICAL DESIGN, INC. (WED) AND SHALL NOT BE COPIED, REPRODUCED, OR DISCLOSED IN CONNECTION WITH ANY WORK OTHER THAN THE PROJECT FOR WHICH IT HAS BEEN PREPARED, IN WHOLE OR PART, WITHOUT PRIOR WRITTEN AUTHORIZATION FROM WED.

© 2019 WILKINSON ECOLOGICAL DESIGN, INC.

SURVEY PROVIDED BY:

SOURATI ENGINEERING GROUP
 107 BEACH ROAD, SUITE 202
 VINEYARD HAVEN, MA, 02568
 508-693-9933

NOTES:

- APPROXIMATELY THREE GROWING SEASONS WILL BE REQUIRED TO CONTROL AND/OR ERADICATE INVASIVE PLANT SPECIES. AFTER THREE GROWING SEASONS, MONITORING AND MINIMAL MAINTENANCE WILL BE ONGOING.
- IF HERBICIDES ARE REQUIRED, THEY ARE TO BE APPLIED BY LICENSED INDIVIDUALS ONLY.
- A TEMPORARY, AUTOMATED ABOVE-GROUND IRRIGATION SYSTEM WILL BE REQUIRED FOR THE FIRST TWO/THREE GROWING SEASONS WHILE NEW PLANTS ARE ESTABLISHING. ONCE PLANTS ARE ESTABLISHED IRRIGATION WILL BE REMOVED.
- ALL RESTORATION PLANTINGS WILL INCORPORATE EXISTING NATIVE SPECIES UNLESS OTHERWISE SPECIFIED IN THE APPROVED DOCUMENTS.
- ANY DISCREPANCIES BETWEEN THE PLANTING SPECIFICATION AND THE PLAN, THE PLAN SHALL TAKE PRECEDENCE.
- HAND-WEEDING AND SELECTIVE HERBICIDE TREATMENTS WILL BE REQUESTED AS AN ONGOING CONDITION TO STOP REINTRODUCTION OF INVASIVE AND AGGRESSIVE PLANT SPECIES INTO THE PROJECT AREA.
- ALL EXPOSED SOILS WILL BE SEEDED WITH NATIVE CAPE COD MEADOW MIX UNLESS OTHERWISE SPECIFIED.
- PROJECT TO BE OVERSEEN AND MAINTAINED BY A CERTIFIED ECOLOGICAL RESTORATION PRACTITIONER (CERP).

LEGEND:

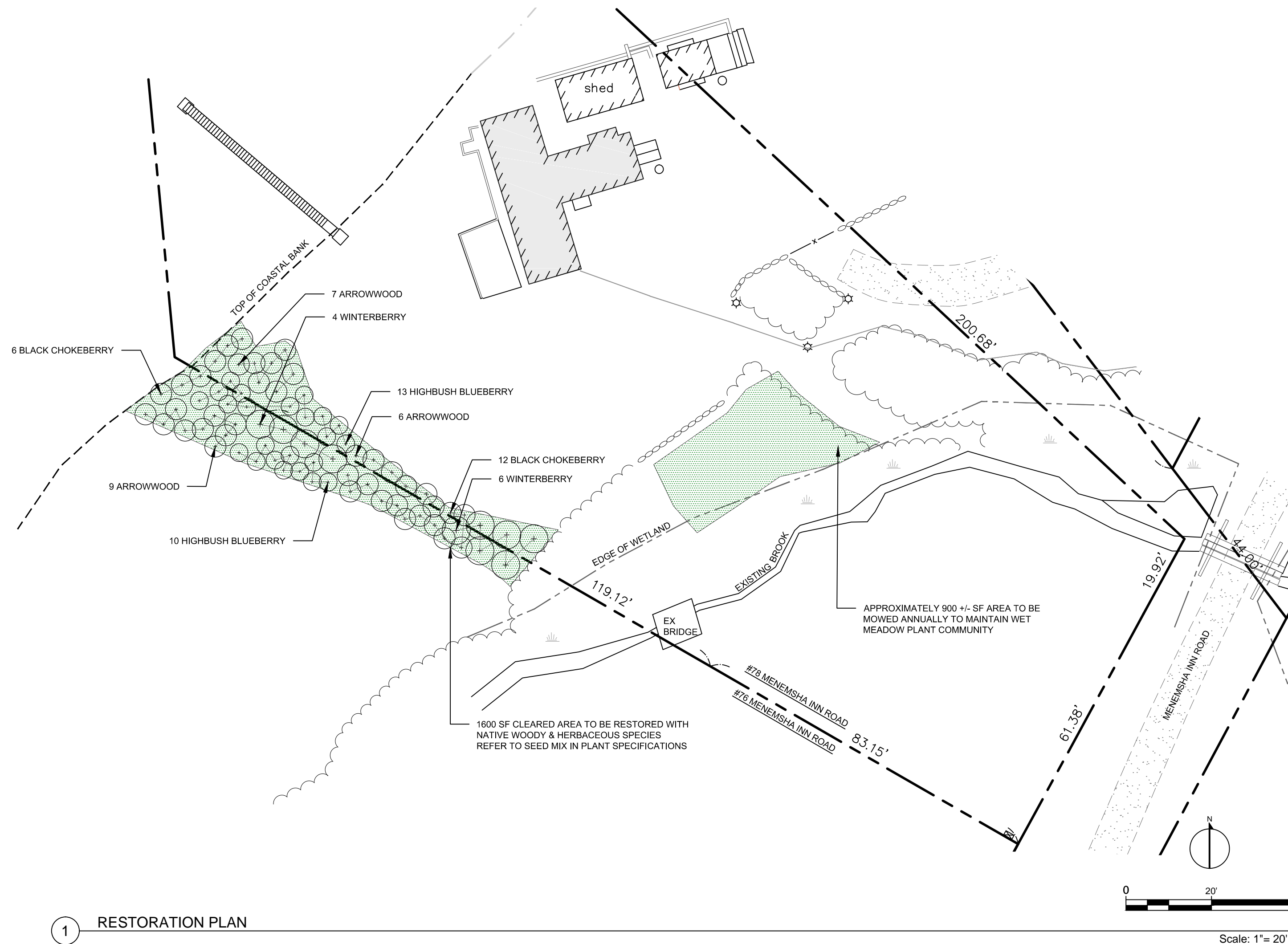

1 RESTORATION PLAN

NATIVE SHRUBS FOR RESTORATION AREAS

qty	common name	scientific name	size
22	Arrowwood	<i>Viburnum dentatum</i>	4'-5' B&B
23	Highbush Blueberry	<i>Vaccinium corymbosum</i>	4'-5' B&B
10	Winterberry	<i>Ilex verticillata</i>	4'-5' B&B
18	Black Chokeberry	<i>Aronia melanocarpa</i>	4'-5' B&B

NATIVE SEED MIX FOR RESTORATION AREAS

common name	scientific name
Broom Sedge	<i>Andropogon virginicus</i>
Creeping Red Fescue	<i>Festuca rubra</i>
Crinkle Hair Grass	<i>Deschampsia flexuosa</i>
Fox Sedge	<i>Carex vulpinoidea</i>
Little Bluestem	<i>Schizachyrium scoparium</i>
Purple Lovegrass	<i>Eragrostis spectabilis</i>
Upland Bentgrass	<i>Agrostis perennans</i>

REV	DATE	DESCRIPTION

Labaree
 78 Menemsha Inn Road
 Chilmark, MA

DATE: 06/17/2019	SCALE: 1" = 20'-0"
DRAWN BY: TK	CHECKED BY: AM

FOR PERMITTING PURPOSES ONLY
 THIS DRAWING IS NOT INTENDED FOR
 CONSTRUCTION

RESTORATION PLAN **1 OF 1**