



WPA Form 1- Request for Determination of Applicability

Massachusetts Wetlands Protection Act M.G.L. c. 131, §40

A. General Information

Important:
When filling out forms on the computer, use only the tab key to move your cursor - do not use the return key.



1. Applicant:

Town of Chilmark Harbor Department
Name
401 Middle Road PO BOX 119
Mailing Address
Chilmark
City/Town
508-645-2846
Phone Number
MA
State
02535
Zip Code
harbormaster@chilmarkma.gov
E-Mail Address
Fax Number (if applicable)

2. Representative (if any):

Town of Chilmark
Firm
Ryan Rossi
Contact Name
401 Middle Road PO BOX 119
Mailing Address
Chilmark
City/Town
508-645-2846
Phone Number
MA
State
02535
Zip Code
harbormaster@chilmarkma.gov
E-Mail Address
Fax Number (if applicable)

B. Determinations

1. I request the Chilmark Conservation Commission make the following determination(s). Check any that apply:

- a. whether the **area** depicted on plan(s) and/or map(s) referenced below is an area subject to jurisdiction of the Wetlands Protection Act.
- b. whether the **boundaries** of resource area(s) depicted on plan(s) and/or map(s) referenced below are accurately delineated.
- c. whether the **work** depicted on plan(s) referenced below is subject to the Wetlands Protection Act.
- d. whether the area and/or work depicted on plan(s) referenced below is subject to the jurisdiction of any **municipal wetlands ordinance** or **bylaw** of:

Name of Municipality

- e. whether the following **scope of alternatives** is adequate for work in the Riverfront Area as depicted on referenced plan(s).



WPA Form 1- Request for Determination of Applicability
Massachusetts Wetlands Protection Act M.G.L. c. 131, §40

C. Project Description

1. a. Project Location (use maps and plans to identify the location of the area subject to this request):

Basin Road
Street Address
Chilmark
City/Town

Assessors Map/Plat Number
Parcel/Lot Number

b. Area Description (use additional paper, if necessary):

Menemsha Comfort Station Lot

c. Plan and/or Map Reference(s):

Drawing of comfort station
Title
4/26/22
Date

Title
Date

Title
Date

2. a. Work Description (use additional paper and/or provide plan(s) of work, if necessary):

The Menemsha Buildings and Maintenance Superintendent has begun maintenance to the comfort station located on Basin Road in Menemsha. As the supervisor for this project, I am requesting permission to complete the following work to the lot in preparation for the 2022 summer season.

1. Replacement of the existing ramps leading to the mens and womens room entrances.
2. Grade the area in front of the comfort station and spread clamshell material to cut down on sand and dirt/mud entering the bulding through foot traffic, and make the area more aesthetically pleasing.
3. Grade the area to the North of the building, outside to the mens shower area where the trash cans, curb stops, and beach walkway are stored for the winter and spread clamshell material.



WPA Form 1- Request for Determination of Applicability

Massachusetts Wetlands Protection Act M.G.L. c. 131, §40

C. Project Description (cont.)

b. Identify provisions of the Wetlands Protection Act or regulations which may exempt the applicant from having to file a Notice of Intent for all or part of the described work (use additional paper, if necessary).

3. a. If this application is a Request for Determination of Scope of Alternatives for work in the Riverfront Area, indicate the one classification below that best describes the project.
- Single family house on a lot recorded on or before 8/1/96
 - Single family house on a lot recorded after 8/1/96
 - Expansion of an existing structure on a lot recorded after 8/1/96
 - Project, other than a single-family house or public project, where the applicant owned the lot before 8/7/96
 - New agriculture or aquaculture project
 - Public project where funds were appropriated prior to 8/7/96
 - Project on a lot shown on an approved, definitive subdivision plan where there is a recorded deed restriction limiting total alteration of the Riverfront Area for the entire subdivision
 - Residential subdivision; institutional, industrial, or commercial project
 - Municipal project
 - District, county, state, or federal government project
 - Project required to evaluate off-site alternatives in more than one municipality in an Environmental Impact Report under MEPA or in an alternatives analysis pursuant to an application for a 404 permit from the U.S. Army Corps of Engineers or 401 Water Quality Certification from the Department of Environmental Protection.
- b. Provide evidence (e.g., record of date subdivision lot was recorded) supporting the classification above (use additional paper and/or attach appropriate documents, if necessary.)



WPA Form 1- Request for Determination of Applicability

Massachusetts Wetlands Protection Act M.G.L. c. 131, §40

D. Signatures and Submittal Requirements

I hereby certify under the penalties of perjury that the foregoing Request for Determination of Applicability and accompanying plans, documents, and supporting data are true and complete to the best of my knowledge.

I further certify that the property owner, if different from the applicant, and the appropriate DEP Regional Office were sent a complete copy of this Request (including all appropriate documentation) simultaneously with the submittal of this Request to the Conservation Commission.

Failure by the applicant to send copies in a timely manner may result in dismissal of the Request for Determination of Applicability.

Name and address of the property owner:

Town of Chilmark

Name

401 Middle Rd. PO Box 119

Mailing Address

Chilmark

City/Town

MA

State

02535

Zip Code

Signatures:

I also understand that notification of this Request will be placed in a local newspaper at my expense in accordance with Section 10.05(3)(b)(1) of the Wetlands Protection Act regulations.

Signature of Applicant

4/26/22

Date

Signature of Representative (if any)

Date

Mememsha Comfort Station

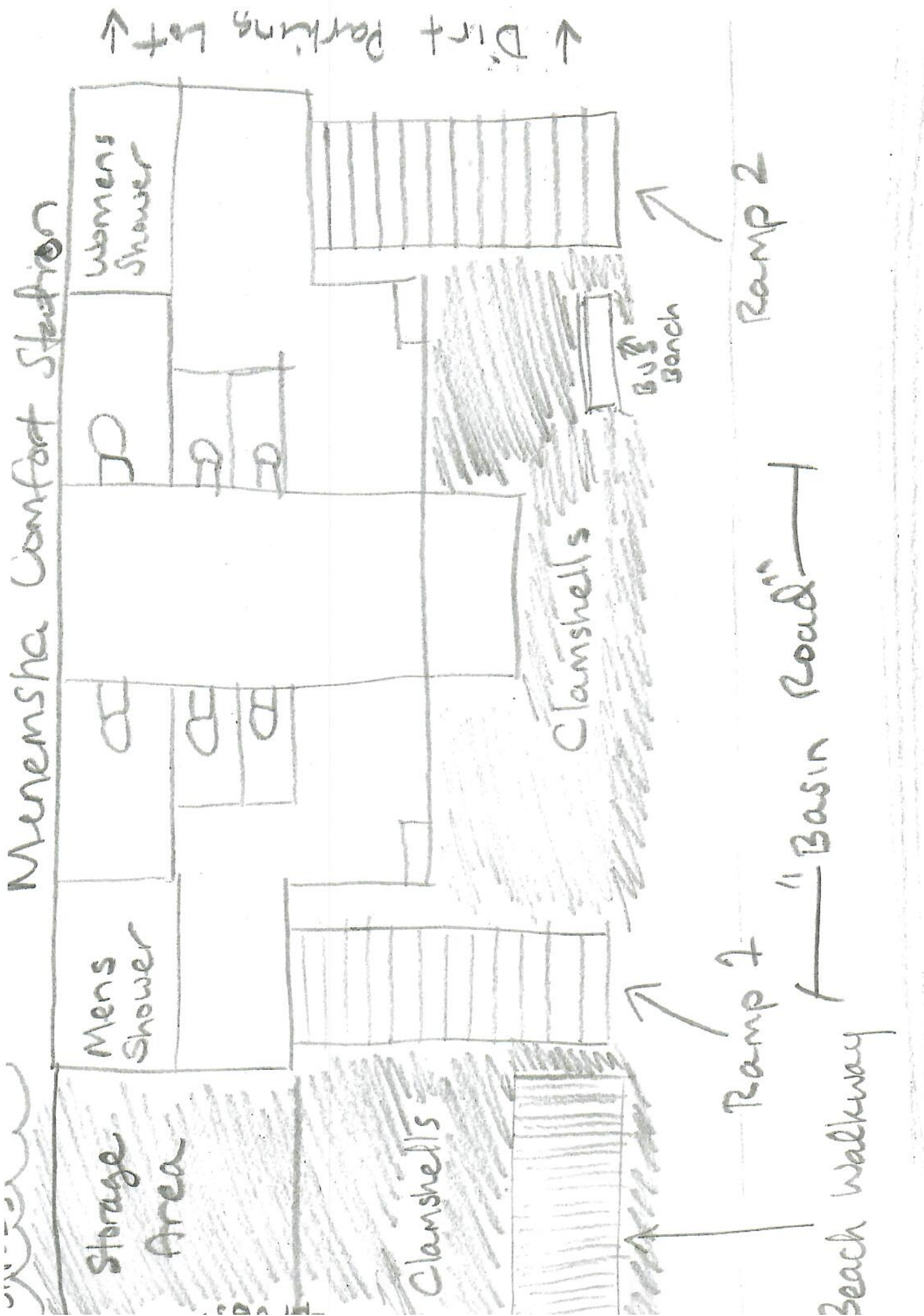

Storage Area

Mens Shower

Womens Shower

Clamshells

Clamshells

Bus Bench

Ramp 1

Ramp 2

Beach Walkway

Basin Road

Dirt Parkings Lot