



[www.souratigroup.com](http://www.souratigroup.com)

Martha's Vineyard Office  
107 Beach Rd., Suite 202  
P.O. Box 4458, Vineyard Haven, MA 02568  
Phone: 508-693-9933, Fax: 508-693-4933

Nantucket Office:  
35 Old South Road, Nantucket, MA 02554  
Phone: 508-228-7888, Fax: 508-228-5511

May 20, 2021

Chilmark Conservation Commission  
P.O. Box 119  
Chilmark, MA 02535

RE: **James E. & Joan Hartley**  
**Map 11, Parcel 25.1**  
**72 Cobb's Hill Road**  
**Chilmark, MA**

Dear Commission Members:

Please find enclosed the Notice of Intent and its supporting documents for proposed work at the above referenced property. Enclosed is a check for \$110.00 for the town filing fee.

Supporting documents enclosed:

- USGS map
- NHESP map
- Copy of WPA Appendix A Wetland Fee Transmittal Form
- Copy of filing fee checks to the Commonwealth of Massachusetts and the Town of Chilmark
- Notice to Abutters, Abutters List, Assessor's Map and Affidavit of Service
- Site Plan in Chilmark, MA prepared for James E. and Joan Hartley by Sourati Engineering Group, LLC dated March 31, 2021.
- Hartley Residence Pool Garden – Pool Sections prepared by Matthew Cunningham Landscape Design LLC dated May 2021 (3 sheets).

Please feel free to contact me directly if you have any questions.

Sincerely,

A handwritten signature in blue ink that reads "George Sourati".

George A. Sourati, P.E.

Cc: DEP-Wetlands Section-Southeast Regional Office

SEG 102319

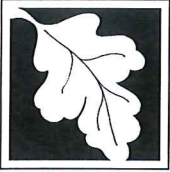

Massachusetts Department of Environmental Protection  
Bureau of Resource Protection - Wetlands

## WPA Form 3 – Notice of Intent

Massachusetts Wetlands Protection Act M.G.L. c. 131, §40  
*and the Chilmark Wetlands Protection By-law*

Provided by MassDEP:

MassDEP File Number

Document Transaction Number

Chilmark

City/Town

**Important:**  
When filling out forms on the computer, use only the tab key to move your cursor - do not use the return key.



**Note:**  
Before completing this form consult your local Conservation Commission regarding any municipal bylaw or ordinance.

### A. General Information

1. Project Location (**Note:** electronic filers will click on button to locate project site):

72 Cobb's Hill Road

a. Street Address

Chilmark

b. City/Town

02535

c. Zip Code

Latitude and Longitude:

11

f. Assessors Map/Plat Number

41.369920

d. Latitude

-70.670120

e. Longitude

25.1

g. Parcel /Lot Number

2. Applicant:

James E. & Joan

a. First Name

Hartley

b. Last Name

c. Organization

500 Chase Parkway

d. Street Address

Waterbury

e. City/Town

CT

f. State

06708

g. Zip Code

h. Phone Number

i. Fax Number

j. Email Address

3. Property owner (required if different from applicant):  Check if more than one owner

a. First Name

b. Last Name

c. Organization

d. Street Address

e. City/Town

f. State

g. Zip Code

h. Phone Number

i. Fax Number

j. Email address

4. Representative (if any):

George

a. First Name

Sourati

b. Last Name

Sourati Engineering Group, LLC

c. Company

107 Beach Road, Suite 202; PO Box 4458

d. Street Address

Vineyard Haven

e. City/Town

MA

f. State

02568

g. Zip Code

(508) 693-9933

h. Phone Number

(508) 693-4933

i. Fax Number

gsourati@souratigroup.com

j. Email address

5. Total WPA Fee Paid (from NOI Wetland Fee Transmittal Form):

\$110.00

a. Total Fee Paid

\$42.50

b. State Fee Paid

\$67.50

c. City/Town Fee Paid

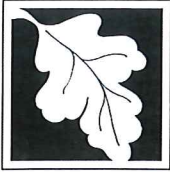

Massachusetts Department of Environmental Protection  
Bureau of Resource Protection - Wetlands

### WPA Form 3 – Notice of Intent

Massachusetts Wetlands Protection Act M.G.L. c. 131, §40

Provided by MassDEP:
MassDEP File Number
Document Transaction Number
Chilmark
City/Town

#### A. General Information (continued)

6. General Project Description:

The project consists of constructing a swimming pool and a pool fence within 100' of a Coastal Bank and partially below the 100-year flood elevation.

7a. Project Type Checklist: (Limited Project Types see Section A. 7b.)

- 1.  Single Family Home
- 2.  Residential Subdivision
- 3.  Commercial/Industrial
- 4.  Dock/Pier
- 5.  Utilities
- 6.  Coastal engineering Structure
- 7.  Agriculture (e.g., cranberries, forestry)
- 8.  Transportation
- 9.  Other

7b. Is any portion of the proposed activity eligible to be treated as a limited project (including Ecological Restoration Limited Project) subject to 310 CMR 10.24 (coastal) or 310 CMR 10.53 (inland)?

- 1.  Yes  No      If yes, describe which limited project applies to this project. (See 310 CMR 10.24 and 10.53 for a complete list and description of limited project types)

2. Limited Project Type

If the proposed activity is eligible to be treated as an Ecological Restoration Limited Project (310 CMR10.24(8), 310 CMR 10.53(4)), complete and attach Appendix A: Ecological Restoration Limited Project Checklist and Signed Certification.

8. Property recorded at the Registry of Deeds for:

Dukes	
a. County	b. Certificate # (if registered land)
1419	355
c. Book	d. Page Number

#### B. Buffer Zone & Resource Area Impacts (temporary & permanent)

- 1.  Buffer Zone Only – Check if the project is located only in the Buffer Zone of a Bordering Vegetated Wetland, Inland Bank, or Coastal Resource Area.
- 2.  Inland Resource Areas (see 310 CMR 10.54-10.58; if not applicable, go to Section B.3, Coastal Resource Areas).

Check all that apply below. Attach narrative and any supporting documentation describing how the project will meet all performance standards for each of the resource areas altered, including standards requiring consideration of alternative project design or location.

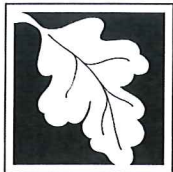

Massachusetts Department of Environmental Protection  
Bureau of Resource Protection - Wetlands

## WPA Form 3 – Notice of Intent

Massachusetts Wetlands Protection Act M.G.L. c. 131, §40

Provided by MassDEP:

MassDEP File Number

Document Transaction Number

Chilmark

City/Town

### B. Buffer Zone & Resource Area Impacts (temporary & permanent) (cont'd)

For all projects affecting other Resource Areas, please attach a narrative explaining how the resource area was delineated.

<u>Resource Area</u>	<u>Size of Proposed Alteration</u>	<u>Proposed Replacement (if any)</u>
a. <input type="checkbox"/> Bank	1. linear feet	2. linear feet
b. <input type="checkbox"/> Bordering Vegetated Wetland	1. square feet	2. square feet
c. <input type="checkbox"/> Land Under Waterbodies and Waterways	1. square feet 3. cubic yards dredged	2. square feet

<u>Resource Area</u>	<u>Size of Proposed Alteration</u>	<u>Proposed Replacement (if any)</u>
d. <input type="checkbox"/> Bordering Land Subject to Flooding	1. square feet 3. cubic feet of flood storage lost	2. square feet 4. cubic feet replaced
e. <input type="checkbox"/> Isolated Land Subject to Flooding	1. square feet 2. cubic feet of flood storage lost	3. cubic feet replaced
f. <input type="checkbox"/> Riverfront Area	1. Name of Waterway (if available) - <b>specify coastal or inland</b>	

2. Width of Riverfront Area (check one):

25 ft. - Designated Densely Developed Areas only

100 ft. - New agricultural projects only

200 ft. - All other projects

3. Total area of Riverfront Area on the site of the proposed project:

\_\_\_\_\_ square feet

4. Proposed alteration of the Riverfront Area:

a. total square feet \_\_\_\_\_

b. square feet within 100 ft. \_\_\_\_\_

c. square feet between 100 ft. and 200 ft. \_\_\_\_\_

5. Has an alternatives analysis been done and is it attached to this NOI?  Yes  No

6. Was the lot where the activity is proposed created prior to August 1, 1996?  Yes  No

3.  Coastal Resource Areas: (See 310 CMR 10.25-10.35)

**Note:** for coastal riverfront areas, please complete **Section B.2.f.** above.



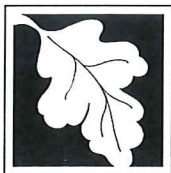

**Massachusetts Department of Environmental Protection**  
 Bureau of Resource Protection - Wetlands

**WPA Form 3 – Notice of Intent**

Massachusetts Wetlands Protection Act M.G.L. c. 131, §40

Provided by MassDEP:

MassDEP File Number
Document Transaction Number
Chilmark
City/Town

**B. Buffer Zone & Resource Area Impacts (temporary & permanent) (cont'd)**

Check all that apply below. Attach narrative and supporting documentation describing how the project will meet all performance standards for each of the resource areas altered, including standards requiring consideration of alternative project design or location.

Online Users:  
 Include your document transaction number (provided on your receipt page) with all supplementary information you submit to the Department.

<u>Resource Area</u>	<u>Size of Proposed Alteration</u>	<u>Proposed Replacement (if any)</u>
a. <input type="checkbox"/> Designated Port Areas	Indicate size under Land Under the Ocean, below	
b. <input type="checkbox"/> Land Under the Ocean	_____	
	1. square feet	
	_____	
	2. cubic yards dredged	
c. <input type="checkbox"/> Barrier Beach	Indicate size under Coastal Beaches and/or Coastal Dunes below	
d. <input type="checkbox"/> Coastal Beaches	_____	_____
	1. square feet	2. cubic yards beach nourishment
e. <input type="checkbox"/> Coastal Dunes	_____	_____
	1. square feet	2. cubic yards dune nourishment
	<u>Size of Proposed Alteration</u>	<u>Proposed Replacement (if any)</u>
f. <input type="checkbox"/> Coastal Banks	_____	
	1. linear feet	
g. <input type="checkbox"/> Rocky Intertidal Shores	_____	
	1. square feet	
h. <input type="checkbox"/> Salt Marshes	_____	_____
	1. square feet	2. sq ft restoration, rehab., creation
i. <input type="checkbox"/> Land Under Salt Ponds	_____	
	1. square feet	
	_____	
	2. cubic yards dredged	
j. <input type="checkbox"/> Land Containing Shellfish	_____	
	1. square feet	
k. <input type="checkbox"/> Fish Runs	Indicate size under Coastal Banks, inland Bank, Land Under the Ocean, and/or inland Land Under Waterbodies and Waterways, above	
	_____	
	1. cubic yards dredged	
	3,000	
	_____	
	1. square feet	

4.  Restoration/Enhancement  
 If the project is for the purpose of restoring or enhancing a wetland resource area in addition to the square footage that has been entered in Section B.2.b or B.3.h above, please enter the additional amount here.

_____	_____
a. square feet of BVW	b. square feet of Salt Marsh

5.  Project Involves Stream Crossings

_____	_____
a. number of new stream crossings	b. number of replacement stream crossings



Massachusetts Department of Environmental Protection  
Bureau of Resource Protection - Wetlands

## WPA Form 3 – Notice of Intent

Massachusetts Wetlands Protection Act M.G.L. c. 131, §40

Provided by MassDEP:

MassDEP File Number

Document Transaction Number

Chilmark

City/Town

### C. Other Applicable Standards and Requirements

- This is a proposal for an Ecological Restoration Limited Project. Skip Section C and complete Appendix A: Ecological Restoration Limited Project Checklists – Required Actions (310 CMR 10.11).

#### Streamlined Massachusetts Endangered Species Act/Wetlands Protection Act Review

1. Is any portion of the proposed project located in **Estimated Habitat of Rare Wildlife** as indicated on the most recent Estimated Habitat Map of State-Listed Rare Wetland Wildlife published by the Natural Heritage and Endangered Species Program (NHESP)? To view habitat maps, see the *Massachusetts Natural Heritage Atlas* or go to [http://maps.massgis.state.ma.us/PRI\\_EST\\_HAB/viewer.htm](http://maps.massgis.state.ma.us/PRI_EST_HAB/viewer.htm).

- a.  Yes  No **If yes, include proof of mailing or hand delivery of NOI to:**

Natural Heritage and Endangered Species Program  
Division of Fisheries and Wildlife  
1 Rabbit Hill Road  
Westborough, MA 01581

August 1, 2017

b. Date of map

If yes, the project is also subject to Massachusetts Endangered Species Act (MESA) review (321 CMR 10.18). To qualify for a streamlined, 30-day, MESA/Wetlands Protection Act review, please complete Section C.1.c, and include requested materials with this Notice of Intent (NOI); *OR* complete Section C.2.f, if applicable. *If MESA supplemental information is not included with the NOI, by completing Section 1 of this form, the NHESP will require a separate MESA filing which may take up to 90 days to review (unless noted exceptions in Section 2 apply, see below).*

- c. Submit Supplemental Information for Endangered Species Review\*
1.  Percentage/acreage of property to be altered:
 

(a) within wetland Resource Area	percentage/acreage
(b) outside Resource Area	percentage/acreage
  2.  Assessor's Map or right-of-way plan of site
2.  Project plans for entire project site, including wetland resource areas and areas outside of wetlands jurisdiction, showing existing and proposed conditions, existing and proposed tree/vegetation clearing line, and clearly demarcated limits of work \*\*
- (a)  Project description (including description of impacts outside of wetland resource area & buffer zone)
  - (b)  Photographs representative of the site

\* Some projects **not** in Estimated Habitat may be located in Priority Habitat, and require NHESP review (see <http://www.mass.gov/eea/agencies/dfg/dfw/natural-heritage/regulatory-review/>). Priority Habitat includes habitat for state-listed plants and strictly upland species not protected by the Wetlands Protection Act.

\*\* MESA projects may not be segmented (321 CMR 10.16). The applicant must disclose full development plans even if such plans are not required as part of the Notice of Intent process.

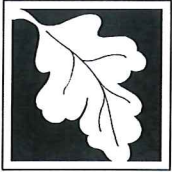

Massachusetts Department of Environmental Protection  
Bureau of Resource Protection - Wetlands

## WPA Form 3 – Notice of Intent

Massachusetts Wetlands Protection Act M.G.L. c. 131, §40

Provided by MassDEP:

MassDEP File Number

Document Transaction Number

Chilmark

City/Town

### C. Other Applicable Standards and Requirements (cont'd)

- (c)  MESA filing fee (fee information available at [http://www.mass.gov/dfwele/dfw/nhosp/regulatory\\_review/ mesa/ mesa\\_fee\\_schedule.htm](http://www.mass.gov/dfwele/dfw/nhosp/regulatory_review/ mesa/ mesa_fee_schedule.htm)). Make check payable to "Commonwealth of Massachusetts - NHESP" and **mail to NHESP** at above address

*Projects altering 10 or more acres of land, also submit:*

- (d)  Vegetation cover type map of site
- (e)  Project plans showing Priority & Estimated Habitat boundaries
- (f) OR Check One of the Following
1.  Project is exempt from MESA review.  
Attach applicant letter indicating which MESA exemption applies. (See 321 CMR 10.14, [http://www.mass.gov/dfwele/dfw/nhosp/regulatory\\_review/ mesa/ mesa\\_exemptions.htm](http://www.mass.gov/dfwele/dfw/nhosp/regulatory_review/ mesa/ mesa_exemptions.htm); the NOI must still be sent to NHESP if the project is within estimated habitat pursuant to 310 CMR 10.37 and 10.59.)
  2.  Separate MESA review ongoing. a. NHESP Tracking # \_\_\_\_\_ b. Date submitted to NHESP \_\_\_\_\_
  3.  Separate MESA review completed.  
Include copy of NHESP "no Take" determination or valid Conservation & Management Permit with approved plan.
3. For coastal projects only, is any portion of the proposed project located below the mean high water line or in a fish run?
- a.  Not applicable – project is in inland resource area only      b.  Yes     No

If yes, include proof of mailing, hand delivery, or electronic delivery of NOI to either:

South Shore - Cohasset to Rhode Island border, and the Cape & Islands:

Division of Marine Fisheries -  
Southeast Marine Fisheries Station  
Attn: Environmental Reviewer  
836 South Rodney French Blvd.  
New Bedford, MA 02744  
Email: [DMF.EnvReview-South@state.ma.us](mailto:DMF.EnvReview-South@state.ma.us)

North Shore - Hull to New Hampshire border:

Division of Marine Fisheries -  
North Shore Office  
Attn: Environmental Reviewer  
30 Emerson Avenue  
Gloucester, MA 01930  
Email: [DMF.EnvReview-North@state.ma.us](mailto:DMF.EnvReview-North@state.ma.us)

Also if yes, the project may require a Chapter 91 license. For coastal towns in the Northeast Region, please contact MassDEP's Boston Office. For coastal towns in the Southeast Region, please contact MassDEP's Southeast Regional Office.



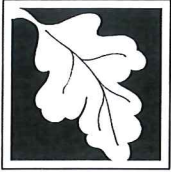

Massachusetts Department of Environmental Protection  
Bureau of Resource Protection - Wetlands

## WPA Form 3 – Notice of Intent

Massachusetts Wetlands Protection Act M.G.L. c. 131, §40

Provided by MassDEP:

MassDEP File Number

Document Transaction Number

Chilmark

City/Town

### C. Other Applicable Standards and Requirements (cont'd)

**Online Users:**  
Include your document transaction number (provided on your receipt page) with all supplementary information you submit to the Department.

4. Is any portion of the proposed project within an Area of Critical Environmental Concern (ACEC)?
- a.  Yes  No      If yes, provide name of ACEC (see instructions to WPA Form 3 or MassDEP Website for ACEC locations). **Note:** electronic filers click on Website.
- b. ACEC
5. Is any portion of the proposed project within an area designated as an Outstanding Resource Water (ORW) as designated in the Massachusetts Surface Water Quality Standards, 314 CMR 4.00?
- a.  Yes  No
6. Is any portion of the site subject to a Wetlands Restriction Order under the Inland Wetlands Restriction Act (M.G.L. c. 131, § 40A) or the Coastal Wetlands Restriction Act (M.G.L. c. 130, § 105)?
- a.  Yes  No
7. Is this project subject to provisions of the MassDEP Stormwater Management Standards?
- a.  Yes. Attach a copy of the Stormwater Report as required by the Stormwater Management Standards per 310 CMR 10.05(6)(k)-(q) and check if:
1.  Applying for Low Impact Development (LID) site design credits (as described in Stormwater Management Handbook Vol. 2, Chapter 3)
  2.  A portion of the site constitutes redevelopment
  3.  Proprietary BMPs are included in the Stormwater Management System.
- b.  No. Check why the project is exempt:
1.  Single-family house
  2.  Emergency road repair
  3.  Small Residential Subdivision (less than or equal to 4 single-family houses or less than or equal to 4 units in multi-family housing project) with no discharge to Critical Areas.

### D. Additional Information

- This is a proposal for an Ecological Restoration Limited Project. Skip Section D and complete Appendix A: Ecological Restoration Notice of Intent – Minimum Required Documents (310 CMR 10.12).

Applicants must include the following with this Notice of Intent (NOI). See instructions for details.

**Online Users:** Attach the document transaction number (provided on your receipt page) for any of the following information you submit to the Department.

1.  USGS or other map of the area (along with a narrative description, if necessary) containing sufficient information for the Conservation Commission and the Department to locate the site. (Electronic filers may omit this item.)
2.  Plans identifying the location of proposed activities (including activities proposed to serve as a Bordering Vegetated Wetland [BVW] replication area or other mitigating measure) relative to the boundaries of each affected resource area.



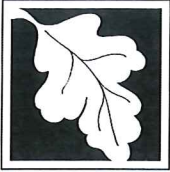

**Massachusetts Department of Environmental Protection**  
Bureau of Resource Protection - Wetlands

**WPA Form 3 – Notice of Intent**

Massachusetts Wetlands Protection Act M.G.L. c. 131, §40

Provided by MassDEP:

MassDEP File Number

Document Transaction Number

Chilmark

City/Town

**D. Additional Information (cont'd)**

3.  Identify the method for BVW and other resource area boundary delineations (MassDEP BVW Field Data Form(s), Determination of Applicability, Order of Resource Area Delineation, etc.), and attach documentation of the methodology.

4.  List the titles and dates for all plans and other materials submitted with this NOI.

(see attached)

a. Plan Title

b. Prepared By

c. Signed and Stamped by

d. Final Revision Date

e. Scale

f. Additional Plan or Document Title

g. Date

5.  If there is more than one property owner, please attach a list of these property owners not listed on this form.
6.  Attach proof of mailing for Natural Heritage and Endangered Species Program, if needed.
7.  Attach proof of mailing for Massachusetts Division of Marine Fisheries, if needed.
8.  Attach NOI Wetland Fee Transmittal Form
9.  Attach Stormwater Report, if needed.

**E. Fees**

1.  Fee Exempt: No filing fee shall be assessed for projects of any city, town, county, or district of the Commonwealth, federally recognized Indian tribe housing authority, municipal housing authority, or the Massachusetts Bay Transportation Authority.

Applicants must submit the following information (in addition to pages 1 and 2 of the NOI Wetland Fee Transmittal Form) to confirm fee payment:

10224

2. Municipal Check Number

May 20, 2021

3. Check date

10223

4. State Check Number

May 20, 2021

5. Check date

Sourati Engineering Group, LLC

6. Payor name on check: First Name

Sourati

7. Payor name on check: Last Name



Massachusetts Department of Environmental Protection  
Bureau of Resource Protection - Wetlands

# WPA Form 3 – Notice of Intent

Massachusetts Wetlands Protection Act M.G.L. c. 131, §40

Provided by MassDEP:
MassDEP File Number
Document Transaction Number
Chilmark
City/Town

## F. Signatures and Submittal Requirements

I hereby certify under the penalties of perjury that the foregoing Notice of Intent and accompanying plans, documents, and supporting data are true and complete to the best of my knowledge. I understand that the Conservation Commission will place notification of this Notice in a local newspaper at the expense of the applicant in accordance with the wetlands regulations, 310 CMR 10.05(5)(a).

I further certify under penalties of perjury that all abutters were notified of this application, pursuant to the requirements of M.G.L. c. 131, § 40. Notice must be made by Certificate of Mailing or in writing by hand delivery or certified mail (return receipt requested) to all abutters within 100 feet of the property line of the project location.

1. Signature of Applicant

2. Date

3. Signature of Property Owner (if different)

*George Sorante*

4. Date

*5/20/21*

5. Signature of Representative (if any)

6. Date

### For Conservation Commission:

Two copies of the completed Notice of Intent (Form 3), including supporting plans and documents, two copies of the NOI Wetland Fee Transmittal Form, and the city/town fee payment, to the Conservation Commission by certified mail or hand delivery.

### For MassDEP:

One copy of the completed Notice of Intent (Form 3), including supporting plans and documents, one copy of the NOI Wetland Fee Transmittal Form, and a **copy** of the state fee payment to the MassDEP Regional Office (see Instructions) by certified mail or hand delivery.

### Other:

If the applicant has checked the "yes" box in any part of Section C, Item 3, above, refer to that section and the Instructions for additional submittal requirements.

The original and copies must be sent simultaneously. Failure by the applicant to send copies in a timely manner may result in dismissal of the Notice of Intent.



**Massachusetts Department of Environmental Protection**  
 Bureau of Resource Protection - Wetlands  
**NOI Wetland Fee Transmittal Form**  
 Massachusetts Wetlands Protection Act M.G.L. c. 131, §40

Important: When filling out forms on the computer, use only the tab key to move your cursor - do not use the return key.



**A. Applicant Information**

1. Location of Project:

72 Cobb's Hill Road  
 a. Street Address  
 10223  
 c. Check number  
 Chilmark  
 b. City/Town  
 \$42.50  
 d. Fee amount

2. Applicant Mailing Address:

James E. & Joan  
 a. First Name  
 Hartley  
 b. Last Name  
 c. Organization  
 500 Chase Parkway  
 d. Mailing Address  
 Waterbury  
 e. City/Town  
 CT  
 f. State  
 06708  
 g. Zip Code  
 h. Phone Number  
 i. Fax Number  
 j. Email Address

3. Property Owner (if different):

a. First Name  
 b. Last Name  
 c. Organization  
 d. Mailing Address  
 e. City/Town  
 f. State  
 g. Zip Code  
 h. Phone Number  
 i. Fax Number  
 j. Email Address

**B. Fees**

Fee should be calculated using the following process & worksheet. **Please see Instructions before filling out worksheet.**

**Step 1/Type of Activity:** Describe each type of activity that will occur in wetland resource area and buffer zone.

**Step 2/Number of Activities:** Identify the number of each type of activity.

**Step 3/Individual Activity Fee:** Identify each activity fee from the six project categories listed in the instructions.

**Step 4/Subtotal Activity Fee:** Multiply the number of activities (identified in Step 2) times the fee per category (identified in Step 3) to reach a subtotal fee amount. Note: If any of these activities are in a Riverfront Area in addition to another Resource Area or the Buffer Zone, the fee per activity should be multiplied by 1.5 and then added to the subtotal amount.

**Step 5/Total Project Fee:** Determine the total project fee by adding the subtotal amounts from Step 4.

**Step 6/Fee Payments:** To calculate the state share of the fee, divide the total fee in half and subtract \$12.50. To calculate the city/town share of the fee, divide the total fee in half and add \$12.50.

To calculate filing fees, refer to the category fee list and examples in the instructions for filling out WPA Form 3 (Notice of Intent).



**Massachusetts Department of Environmental Protection**  
 Bureau of Resource Protection - Wetlands  
**NOI Wetland Fee Transmittal Form**  
 Massachusetts Wetlands Protection Act M.G.L. c. 131, §40

**B. Fees** (continued)

Step 1/Type of Activity	Step 2/Number of Activities	Step 3/Individual Activity Fee	Step 4/Subtotal Activity Fee
Category 1.a.	1	\$110.00	\$110.00
_____	_____	_____	_____
_____	_____	_____	_____
_____	_____	_____	_____
_____	_____	_____	_____
_____	_____	_____	_____
_____	_____	_____	_____
_____	_____	_____	_____
<b>Step 5/Total Project Fee:</b>			\$110.00

**Step 6/Fee Payments:**

Total Project Fee:	\$110.00
State share of filing Fee:	\$42.50
City/Town share of filling Fee:	\$67.50
	a. Total Fee from Step 5
	b. 1/2 Total Fee less \$12.50
	c. 1/2 Total Fee plus \$12.50

**C. Submittal Requirements**

- a.) Complete pages 1 and 2 and send with a check or money order for the state share of the fee, payable to the Commonwealth of Massachusetts.

Department of Environmental Protection  
 Box 4062  
 Boston, MA 02211

- b.) **To the Conservation Commission:** Send the Notice of Intent or Abbreviated Notice of Intent; a copy of this form; and the city/town fee payment.

**To MassDEP Regional Office** (see Instructions): Send a copy of the Notice of Intent or Abbreviated Notice of Intent; a copy of this form; and a copy of the state fee payment. (E-filers of Notices of Intent may submit these electronically.)



DEP File Number:

---

Provided by DEP

---

CHILMARK  
Town

#### D. ADDITIONAL INFORMATION

1. USGS Locus Map, Massachusetts – Dukes County
2. Plan identifying the location of proposed activities:
  - Site Plan in Chilmark, MA prepared for James E. and Joan Hartley by Sourati Engineering Group, LLC dated March 31, 2021, scale 1"=30'.
  - Landscape Construction Documents for the Leff/Knight Residence prepared by Pouder Design Group dated April 16, 2021, (3 sheets) scale as noted.
3. Identify the method for BVW and other resource area boundary delineations and attach documentation of the methodology:
  - The resource area boundaries were determined using the three-parameter method that incorporates topography, vegetation and soils.
4. Other materials submitted with this NOI
  - Notification to Abutters dated May 20, 2021, Assessor's 300 foot Abutters List Report and Affidavit of Service
  - NHESP Map, date of map August 1, 2017.

68°56' N, NE  
(NAUSHON ISLAND)

UNITED STATES  
DEPARTMENT OF THE INTERIOR  
GEOLOGICAL SURVEY

USGS LOCUS MAP  
A PORTION OF THE  
CHILMARK QUADRANGLE  
MASSACHUSETTS-DUKES CO.  
7.5 MINUTE SERIES (TOPOGRAPHIC)

70° 42' 30" 358000m E 359 40'

102319 Hartley  
72 Cobb's Hill Road  
Assessor's Map 11, Parcel 25.1  
Chilmark, MA 02535

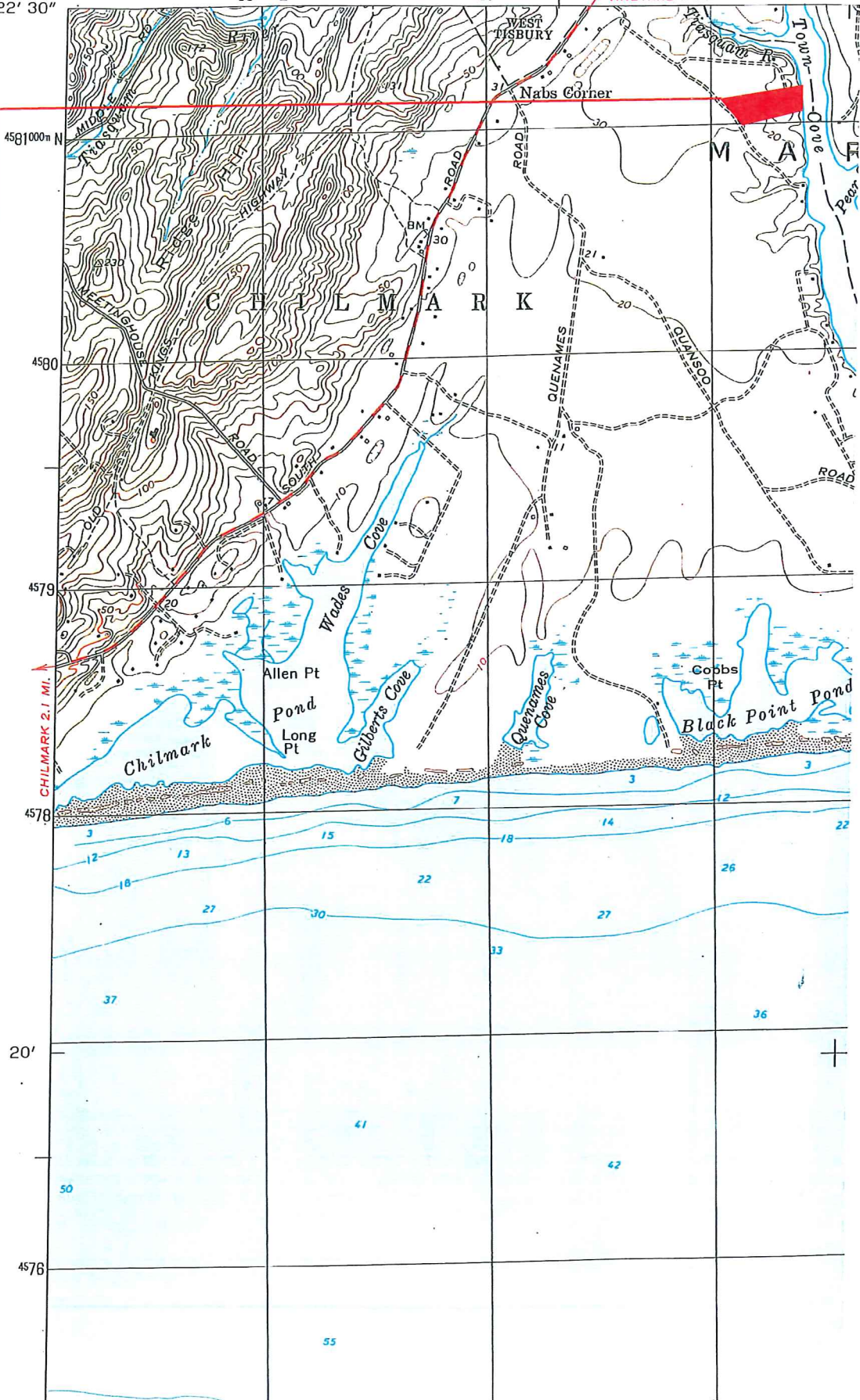

20'

4576







Natural Heritage and Endangered Species Program  
map date August 1, 2017

102319 Hartley  
72 Cobb's Hill Road  
Assessor's Map 11, Parcel 25.1  
Chilmark, MA 02535



www.souratigroup.com

Martha's Vineyard Office  
107 Beach Rd., Suite 202  
P.O. Box 4458, Vineyard Haven, MA 02568  
Phone: 508-693-9933, Fax: 508-693-4933

Nantucket Office:  
35 Old South Road, Nantucket, MA 02554  
Phone: 508-228-7888, Fax: 508-228-5511

May 20, 2021

**Notification to Abutters Under the  
Massachusetts Wetland Protection Act and the  
Town of Chilmark Wetlands Protection Bylaws**

Dear Abutter,

In accordance with the second paragraph of the Massachusetts General Laws Chapter 131, Sec. 40, you are hereby notified of the following:

Name of Applicant Is: **James E. & Joan Hartley**

The applicant has filed a Notice of Intent with the Chilmark Conservation Commission seeking the following: **The project consists of constructing a swimming pool and a pool fence within 100' of a Coastal Bank and partially below the 100-year flood elevation.**

The work is subject to protection under the Wetlands Protection Act (General Laws Chapter 131, Section 40) and the Town of Chilmark Wetlands Protection Bylaws.

The address of the lot where the activity is proposed is:

**72 Cobb's Hill Road, Assessor's Map 11, Parcel 25.1, Chilmark, MA**

Notice of the public meeting/hearing, including the date, time and place will be published at least five days in advance in the Vineyard Gazette or the Martha's Vineyard Times, and will be posted in the Chilmark Town Hall no less than forty-eight (48) hours in advance.

Copies of the application can be examined and information about the date, time and place of the meeting/hearing can be obtained from either the Chilmark Conservation Commission office, Chilmark Town Hall, Monday – Friday, 7:30 a.m. to 4:30 p.m. (508-645-2114) or copies of the application may be viewed at Sourati Engineering Group, LLC, 107 Beach Road, Suite 202, Vineyard Haven, MA 02568, (508-693-9933).

You may also contact the Department of Environmental Protection for more information about this application or the Wetlands Protection Act: 508-946-2800.

Sincerely,

A handwritten signature in black ink that reads "George Sourati". The signature is written in a cursive style.

George A. Sourati, P.E.



**AFFIDAVIT OF SERVICE**

Under the Massachusetts Wetland Protection Act  
And the Town of Chilmark Wetlands Protection Bylaws

I, George A. Sourati, hereby certify under the pains and penalties of perjury that to the best of my knowledge I gave notification to abutters in compliance with the second paragraph of Massachusetts General Laws Chapter 131, Section 40, and the DEP Guide to Abutter Notification dated April 9, 1994, in connection with the following matter:

A Notice of Intent filed under the Wetlands Protection Act and the Town of Chilmark Wetlands Protection Bylaws by **James E. & Joan Hartley** with the Chilmark Conservation Commission for work at property located at **72 Cobb's Hill Road, assessor's map 11, parcel 25.1, Chilmark, Massachusetts.**

The form of notification, and a certified list of the abutters to whom it was given and their addresses, are attached to this Affidavit of Service.

*George Sourati*

George A. Sourati  
Sourati Engineering Group, LLC

*5/21/21*

Date



102319 Hartley, 72 Cobb's Hill Rd, 11-25.1

Chilmark, MA



May 17, 2021

1 inch = 1130 Feet

www.cai-tech.com

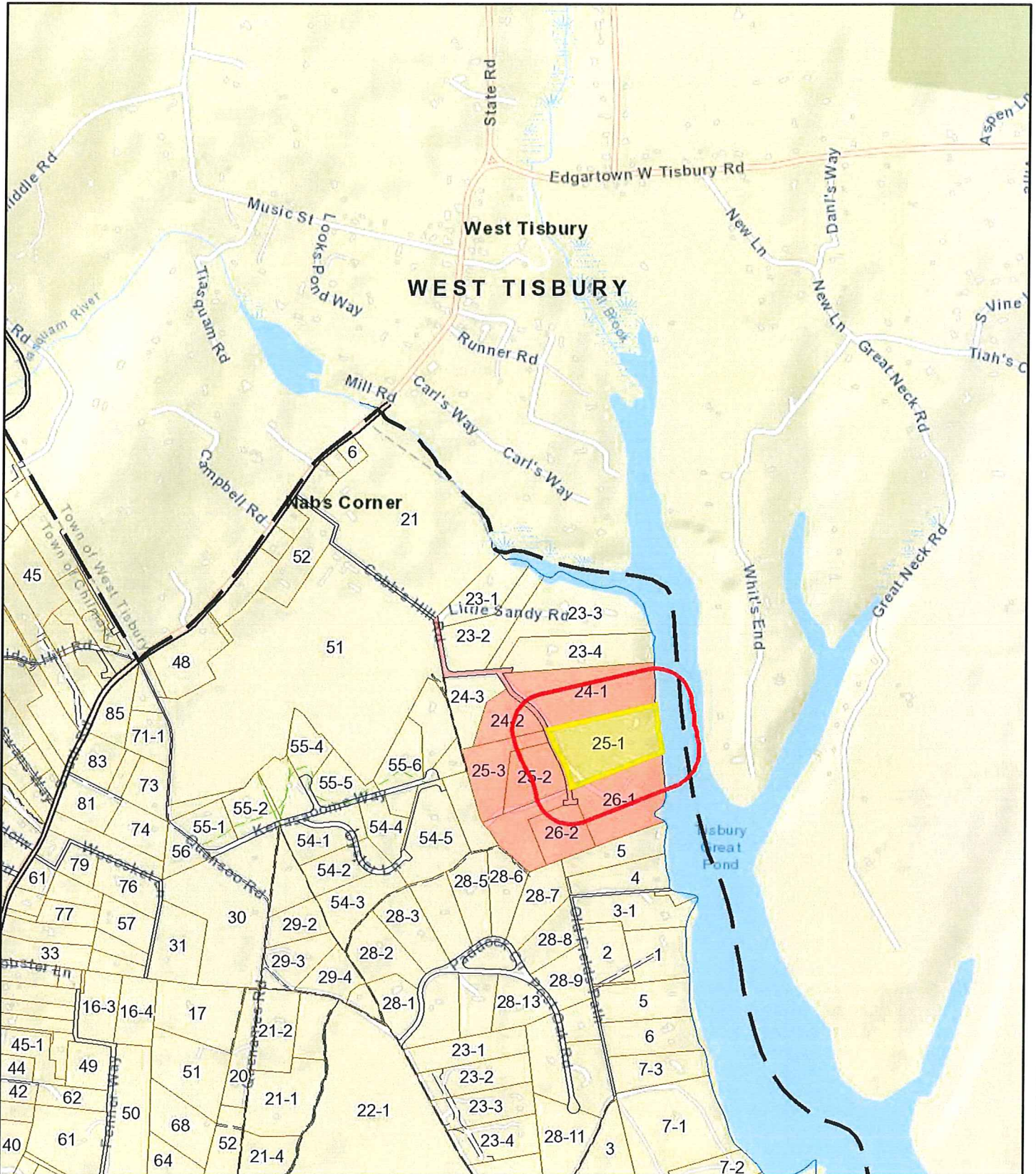

Data shown on this map is provided for planning and informational purposes only. The municipality and CAI Technologies are not responsible for any use for other purposes or misuse or misrepresentation of this map.





# 300 foot Abutters List Report

Chilmark, MA

May 17, 2021

## Subject Property:

Parcel Number: 011-025-01  
CAMA Number: 011-025-01  
Property Address: 72 COBBS HILL RD

Mailing Address: HARTLEY JOAN & JAMES E  
500 CHASE PARKWAY  
WATERBURY, CT 06708

---

## Abutters:

Parcel Number: 011-024-01  
CAMA Number: 011-024-01  
Property Address: 58 COBBS HILL RD

Mailing Address: HIERS MAURICE D JR & JEANNINE H  
SAMPLE T  
C/O: MAURICE D HIERS JR 9 GILMORE  
FARM RD  
WESTBOROUGH, MA 01581

Parcel Number: 011-024-02  
CAMA Number: 011-024-02  
Property Address: 61 COBBS HILL RD

Mailing Address: WOLFF DAVID  
61 COBBS HILL ROAD  
CHILMARK, MA 02535

Parcel Number: 011-025-02  
CAMA Number: 011-025-02  
Property Address: 75 COBBS HILL RD

Mailing Address: GOODMAN JILL M TRUSTEE ;THE JILL  
GOODMAN TRUST  
1100 SOUTH OCEAN BLVD UNIT 4  
DELRAY BEACH, FL 33483

Parcel Number: 011-025-03  
CAMA Number: 011-025-03  
Property Address: 69 COBBS HILL RD

Mailing Address: SEWARD WILL & MICHELLE N K  
159 MADISON AVE. UNIT 11E  
NEW YORK, NY 10016

Parcel Number: 011-026-01  
CAMA Number: 011-026-01  
Property Address: 80 COBBS HILL RD

Mailing Address: WINNINGTON MICHELE T TRUSTEE  
MICHELE QTIP TRUST PO BOX 3118  
WEST TISBURY, MA 02575

Parcel Number: 011-026-02  
CAMA Number: 011-026-02  
Property Address: 82 COBBS HILL RD

Mailing Address: WINNINGTON MICHELE T  
PO BOX 3118  
WEST TISBURY, MA 02575

Parcel Number: 011-026-03  
CAMA Number: 011-026-03  
Property Address: 81 COBBS HILL RD

Mailing Address: MARCUS ADAM D & CARRIE R  
104 WESTCLIFF RD  
WESTON, MA 02493



www.cai-tech.com

10223

**SOURATI ENGINEERING GROUP LLC**  
 107 BEACH RD SUITE 202, PO BOX 4458  
 VINEYARD HAVEN, MA 02568  
 PH. (508) 693-9933

MARTHA'S VINEYARD BANK  
 53-7292/2113

5-20-21

PAY TO THE ORDER OF *Commonwealth of Massachusetts* \$42.50

*Forty-two and 50/100* DOLLARS

MEMO *102319 Hartley  
 Not pool*

*George Sourati*  
 AUTHORIZED SIGNATURE

⑈010223⑈ ⑆211372925⑆ 45 234572⑈

10224

**SOURATI ENGINEERING GROUP LLC**  
 107 BEACH RD SUITE 202, PO BOX 4458  
 VINEYARD HAVEN, MA 02568  
 PH. (508) 693-9933

MARTHA'S VINEYARD BANK  
 53-7292/2113

5-20-21

PAY TO THE ORDER OF *Town of Chilmark* \$67.50

*Sixty-seven and 50/100* DOLLARS

MEMO *102319 Hartley  
 Not local filing fee*

*George Sourati*  
 AUTHORIZED SIGNATURE

⑈010224⑈ ⑆211372925⑆ 45 234572⑈



MAP II  
PARCEL 24.1

MAP II  
PARCEL 26.1

100 YEAR FLOOD EL. 110  
(ZONE AE) (FROM F.E.M.A. F.I.R.M.  
MAP REVISED JULY 20, 2016)

TOP OF COASTAL BANK  
(8-24-2020)

TOP OF COASTAL BANK

BOTTOM OF BANK  
(8-24-2020)

Town Cove

EDGE OF POND

TOP OF COASTAL BANK

EDGE OF WETLANDS

Cobbs Hill Road

10' EASEMENT

NOTES:  
1. LOT AREA: 8.31 ACRES.  
2. DATUM: NAVD 1988.  
3. REFER LANDSCAPE ARCHITECTS PLANS FOR  
DETAILS AND ADDITIONAL INFORMATION -  
MATTHEW CUNNINGHAM LANDSCAPE DESIGN LLC.

Conservation Commission Site Plan  
in  
Chilmark, Massachusetts  
Assessor Parcel 11-25.1  
prepared for  
**Joan & James E. Hartley**  
Scale 1"=30' March 31, 2021

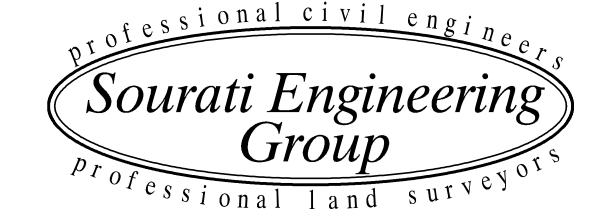

P.O. Box 4458  
107 Beach Road, Suite 202  
Vineyard Haven, MA 02568  
Phone (508) 693-9933 Fax (508) 693-4933



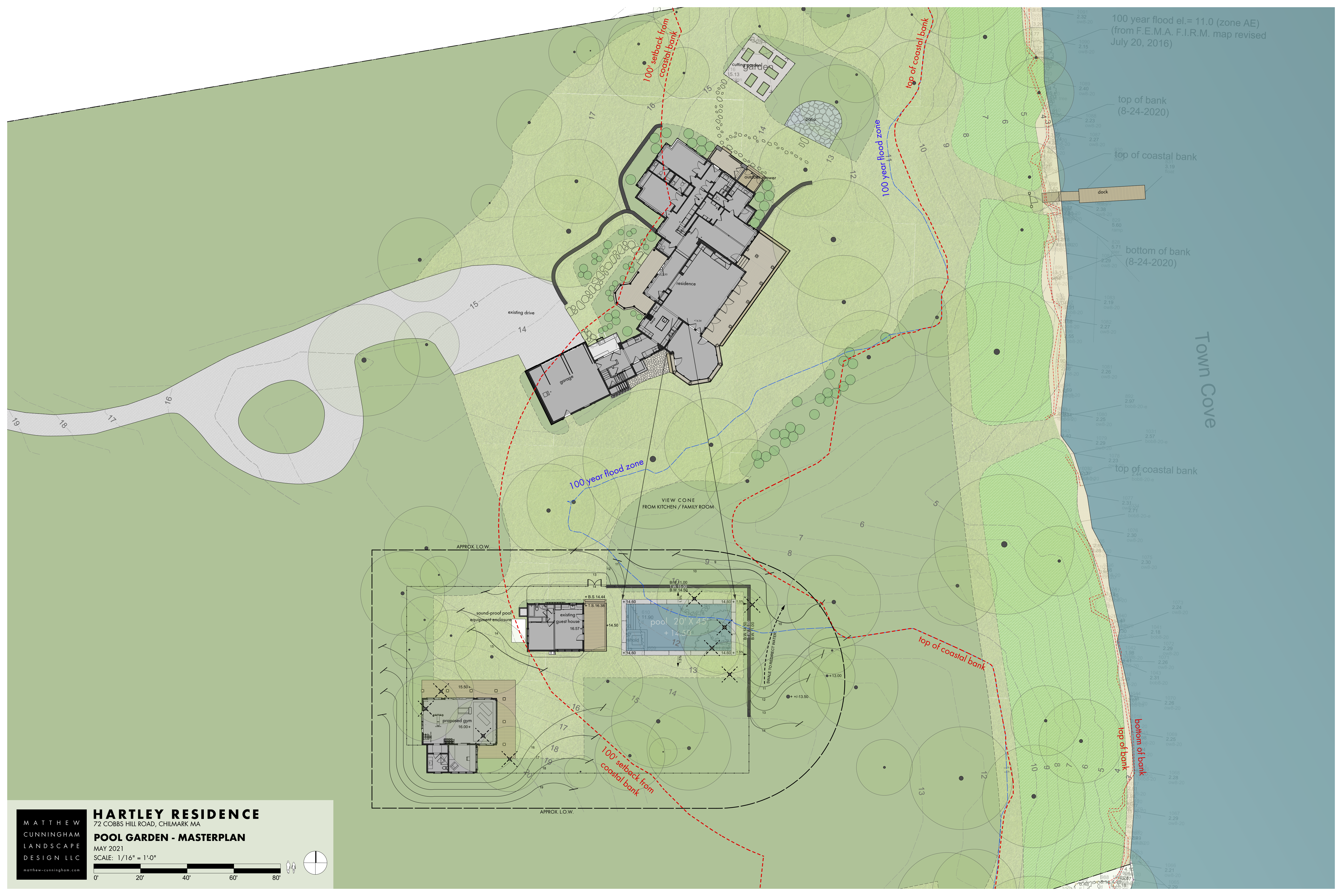

**MATTHEW CUNNINGHAM LANDSCAPE DESIGN LLC**  
 matthew-cunningham.com

**HARTLEY RESIDENCE**  
 72 COBBS HILL ROAD, CHILMARK MA

**POOL GARDEN - MASTERPLAN**  
 MAY 2021  
 SCALE: 1/16" = 1'-0"

0' 20' 40' 60' 80'



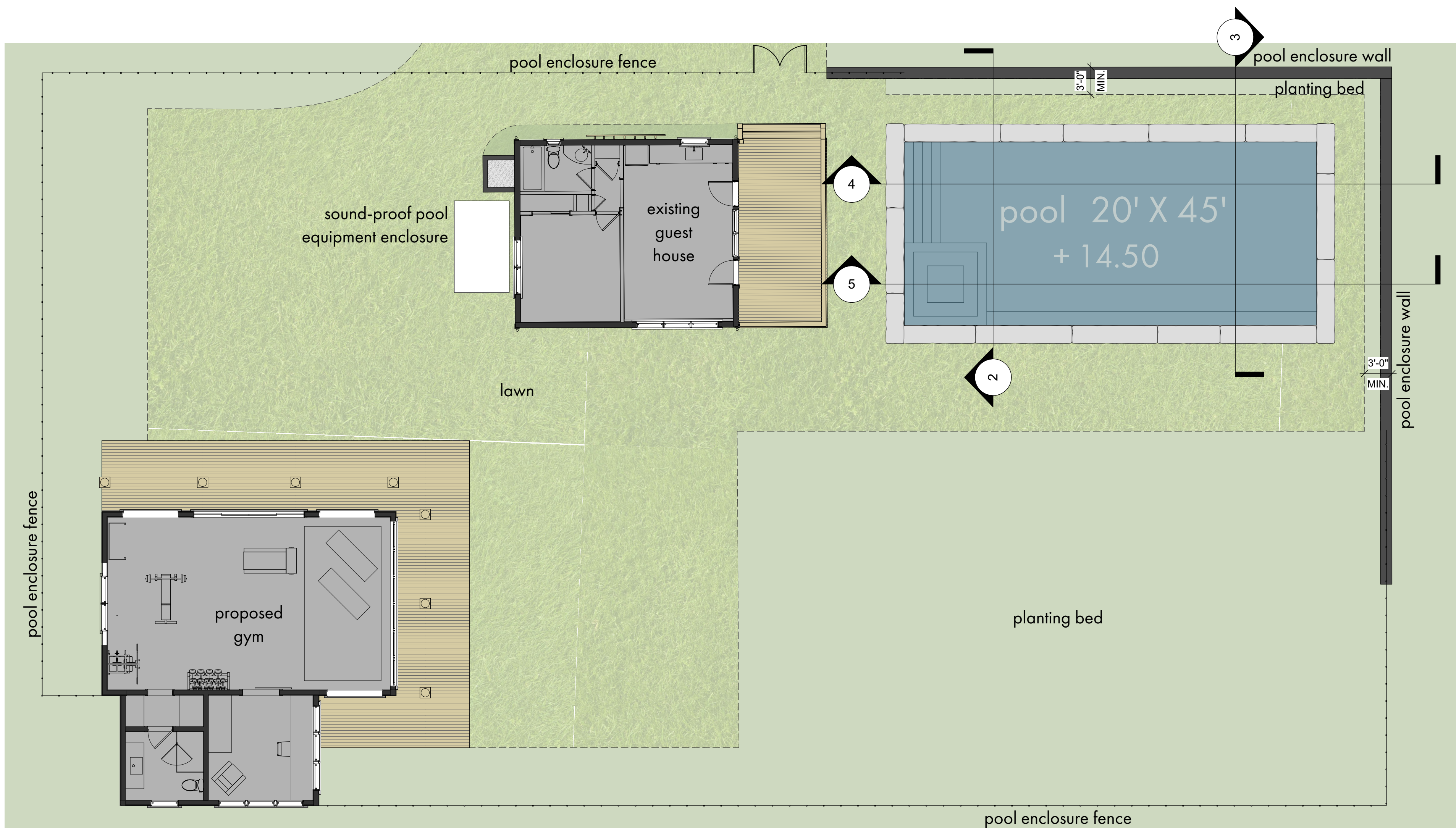

1 POOL GARDEN - ENLARGEMENT PLAN  
Scale: 1/8" = 1'-0"

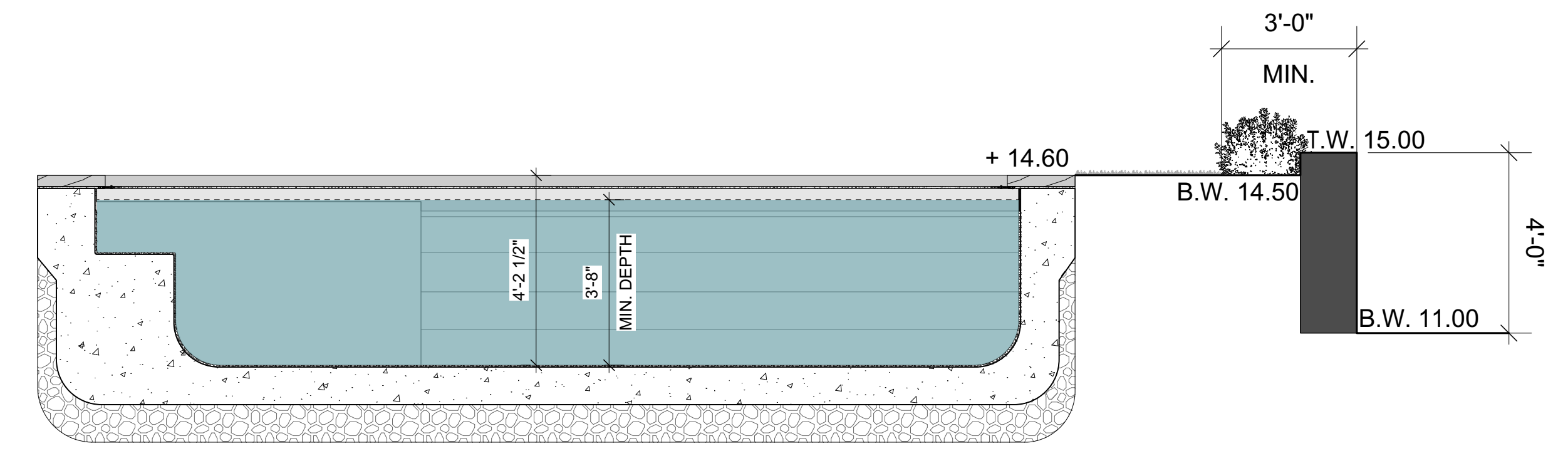

2 POOL - SHALLOW END  
Scale: 3/8" = 1'-0"

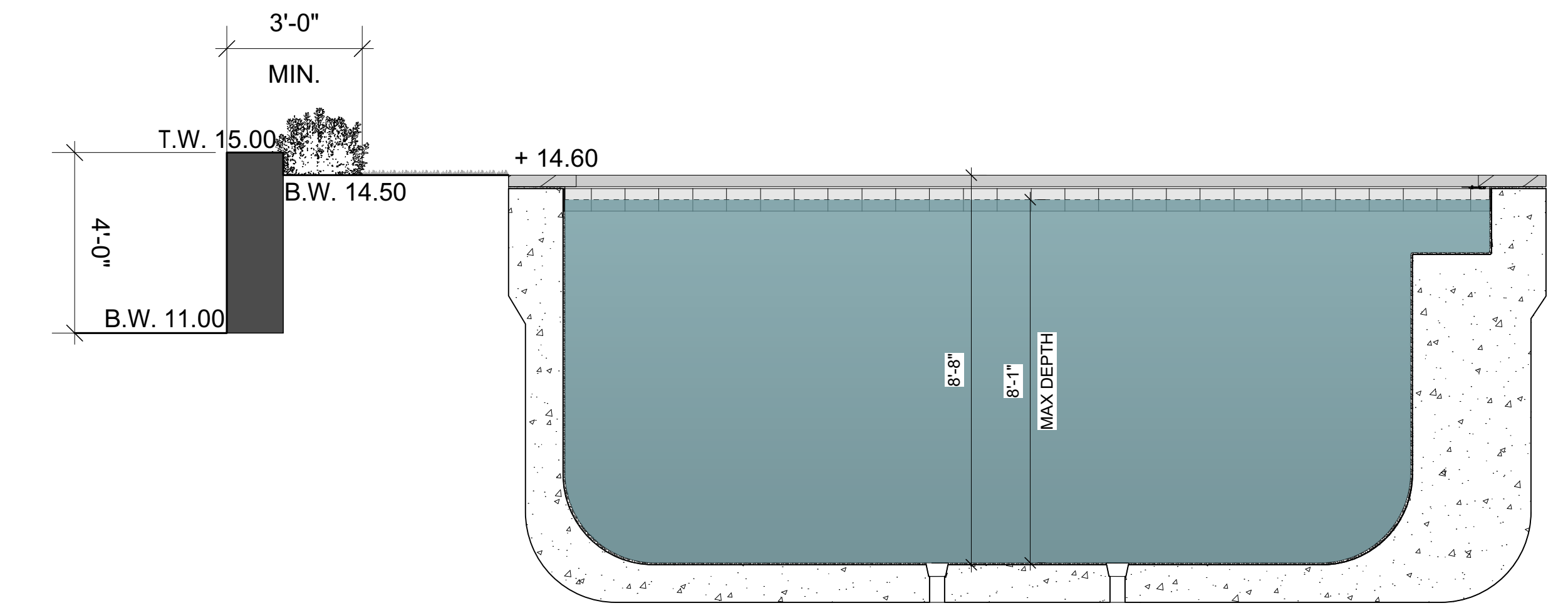

3 POOL - DEEP END  
Scale: 3/8" = 1'-0"

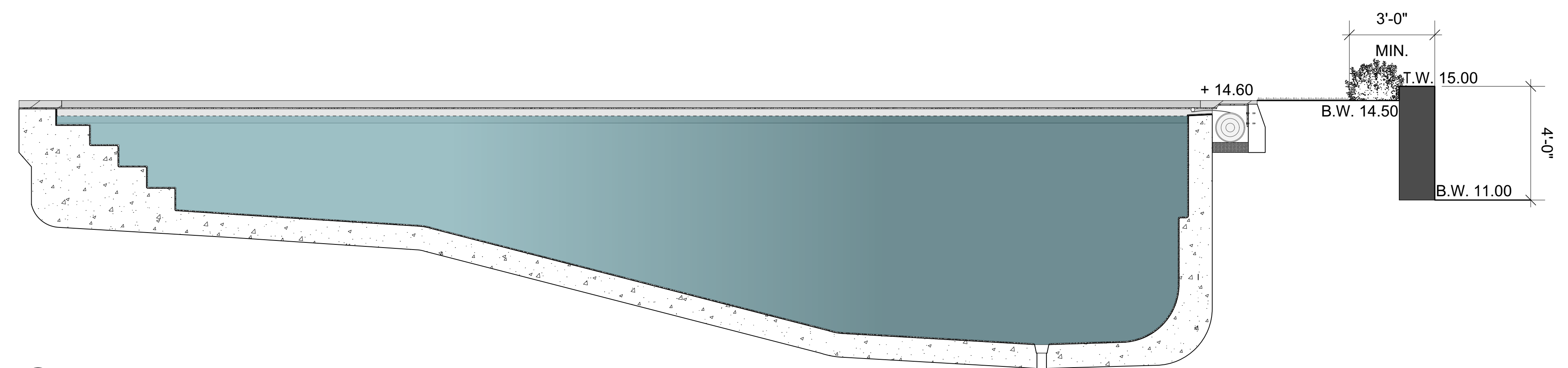

4 POOL - SECTION  
Scale: 3/8" = 1'-0"

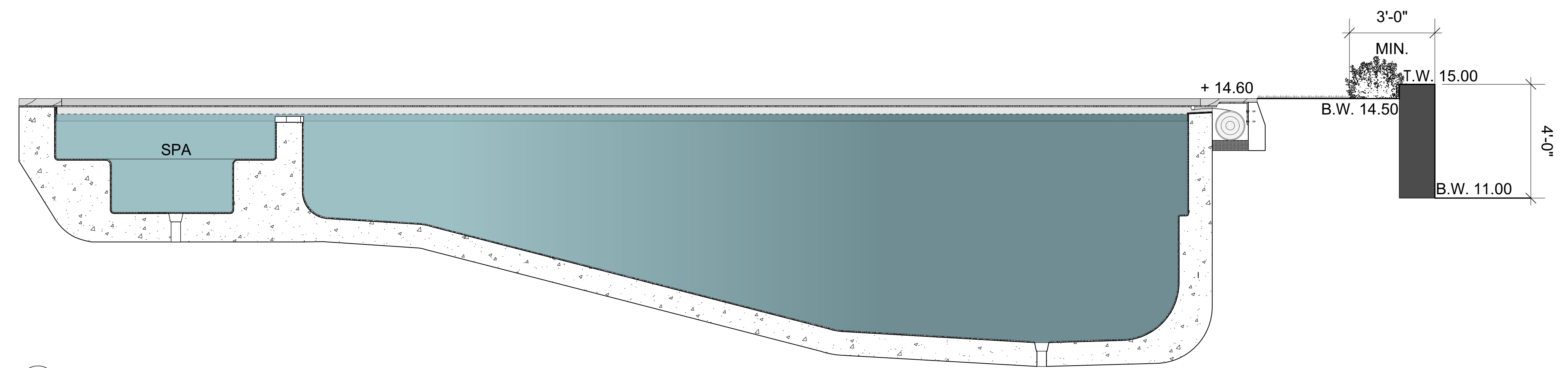

5 POOL - SECTION WITH SPA  
Scale: 3/8" = 1'-0"



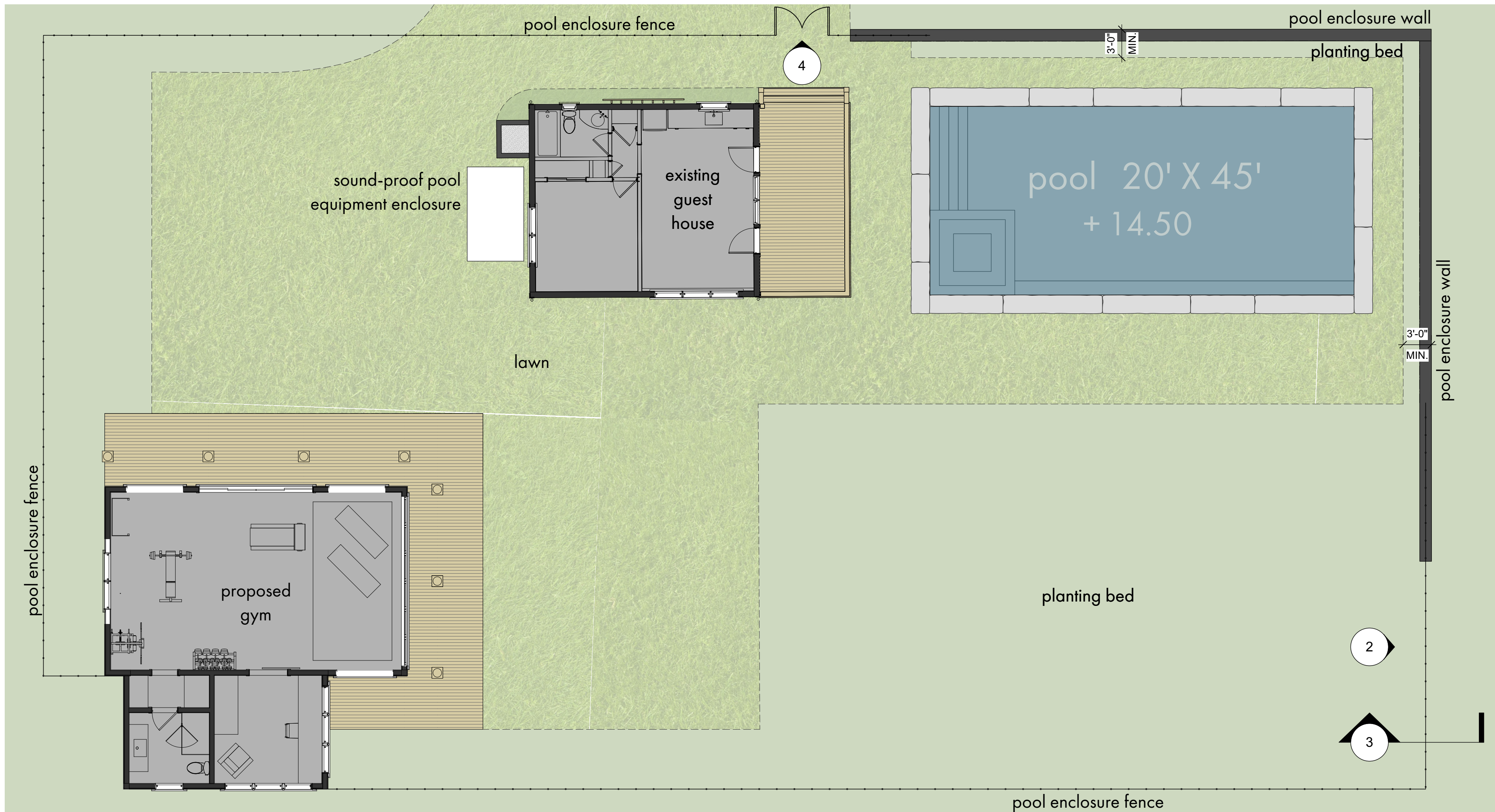

1 POOL GARDEN - ENLARGEMENT PLAN  
Scale: 1/8" = 1'-0"

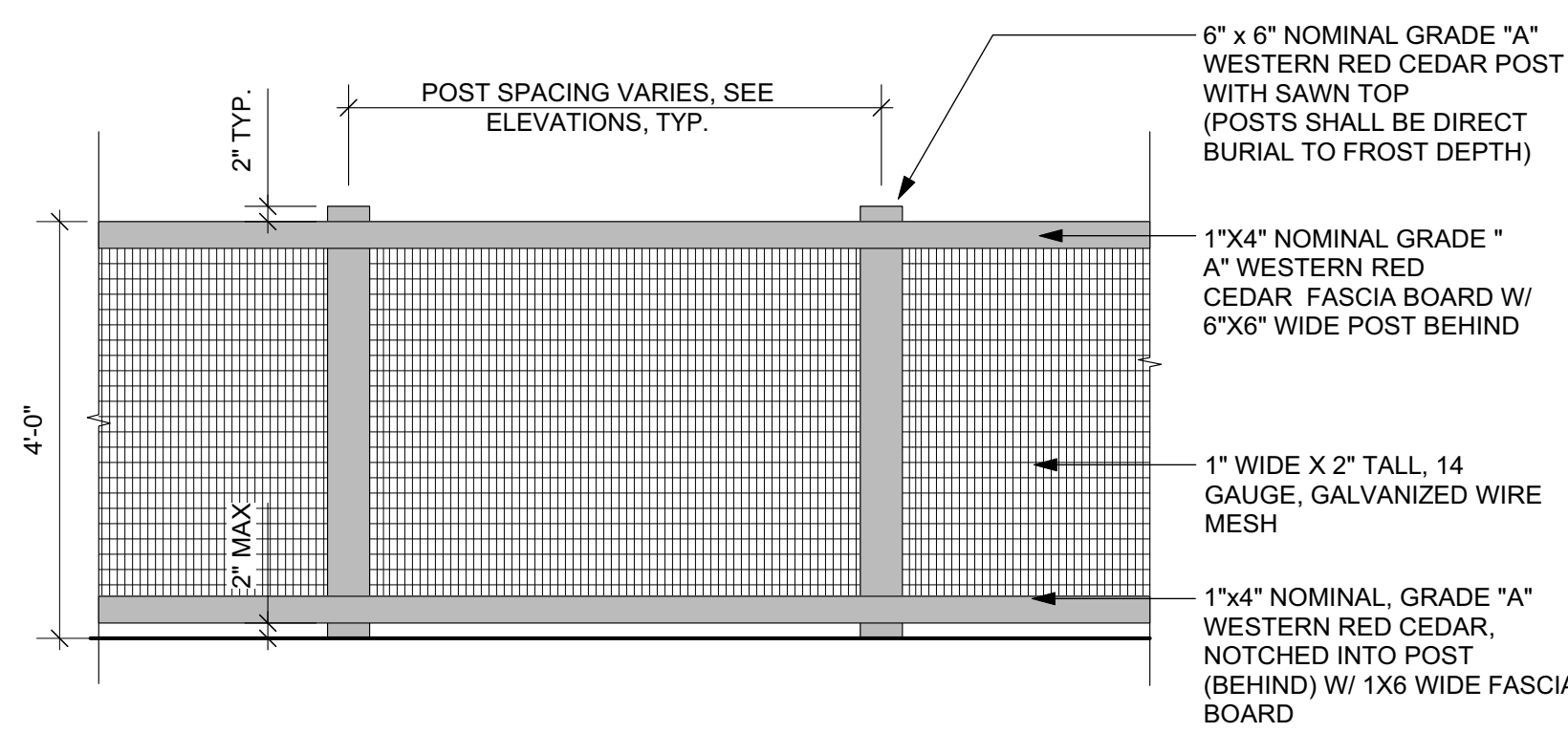

BACK

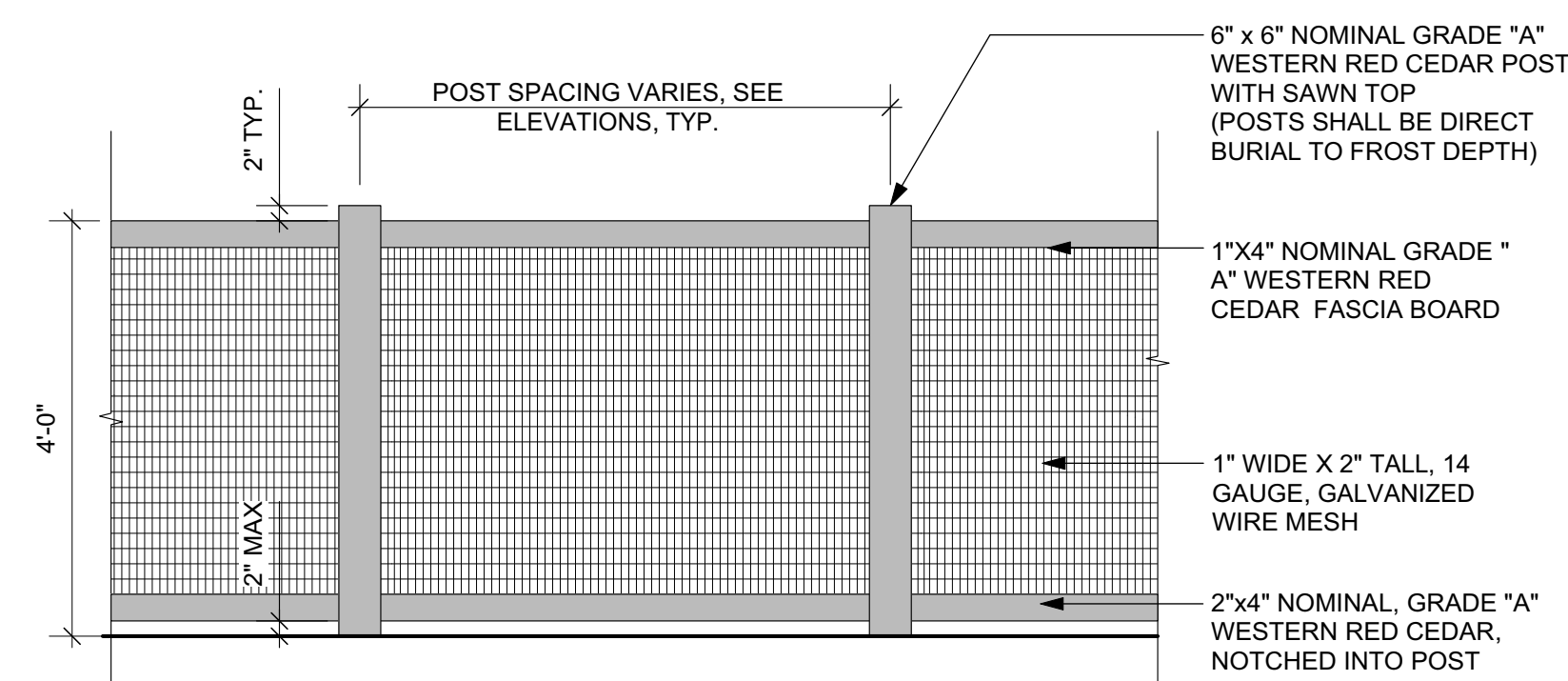

FRONT

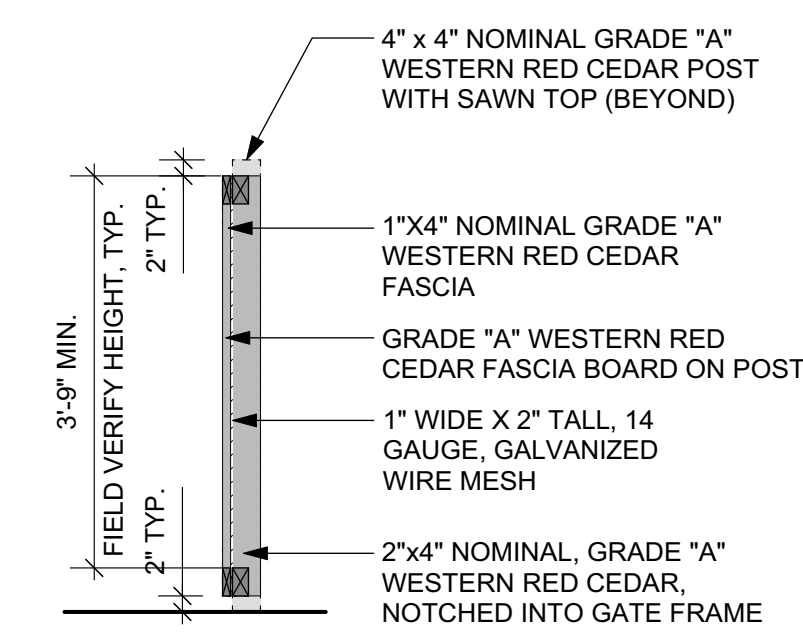

3 POOL ENCLOSURE FENCE POST; TYP.  
Scale: 1/2" = 1'-0"

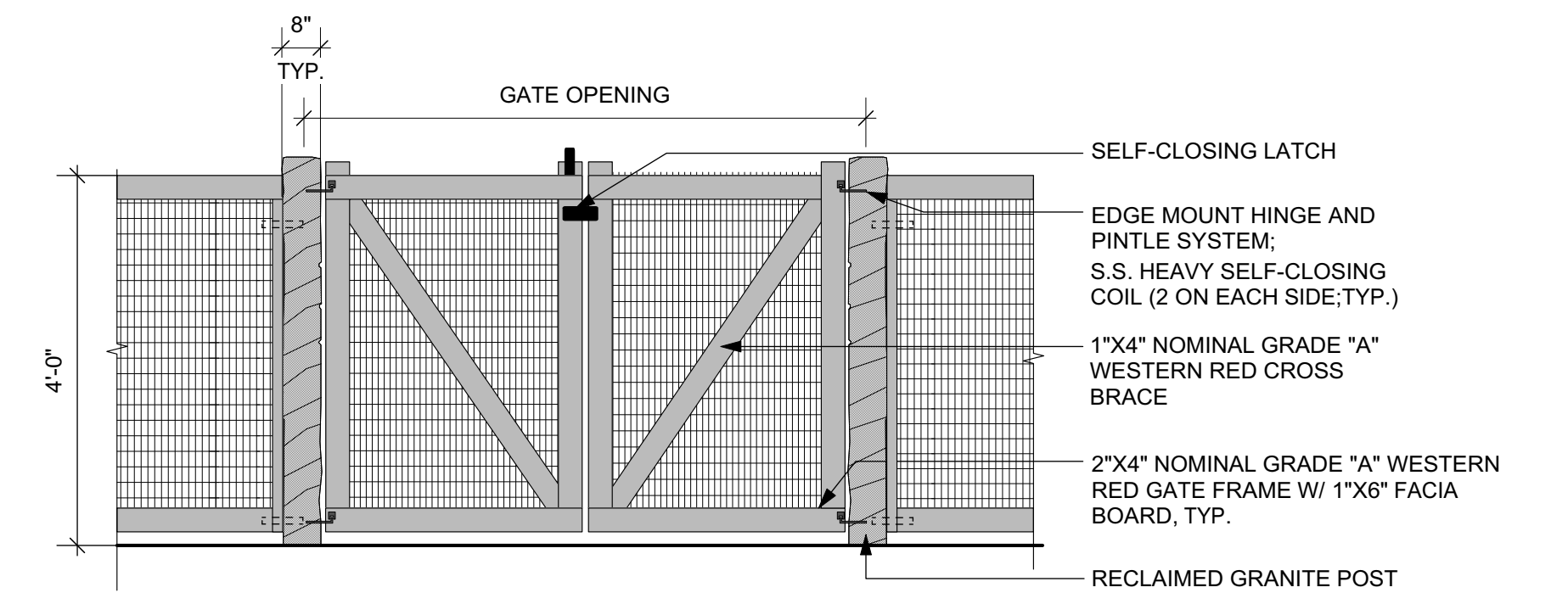

4 POOL ENCLOSURE GATE; TYP.  
Scale: 1/2" = 1'-0"

2 POOL ENCLOSURE FENCE; TYP.  
Scale: 1/2" = 1'-0"