

MAP II  
PARCEL 24.1

100 YEAR FLOOD EL. 11.0  
(ZONE AE) (FROM F.E.M.A. F.I.R.M.  
MAP REVISED JULY 20, 2016)

TOP OF COASTAL BANK  
(8-24-2020)

TOP OF COASTAL BANK

BOTTOM OF BANK  
(8-24-2020)

Town Cove

EDGE OF POND

TOP OF COASTAL BANK

EDGE OF WETLANDS

OUTDOOR SHOWER  
EXISTING GUEST HOUSE  
TO BE REMOVED  
PROPOSED POOL FENCE (TYP.)  
NO VEGETATION EXCEPT FOR  
GRASSES SHALL BE ALLOWED  
WITHIN 4' OF THE POOL FENCE  
OUTDOOR SHOWER  
POOL EQUIPMENT

PROPOSED GUEST HOUSE

PROPOSED POOL HOUSE/BARN

PROPOSED POOL (20'X45')

TOP OF COPING  
EL. 14.1

PROPOSED OFFICE

PROPOSED POOL ENCLOSURE WALL

EDGE OF CLEARING

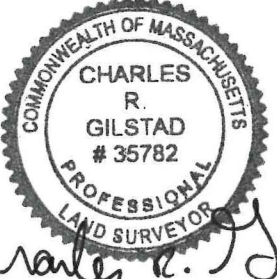

Charles R. Gilstad  
3/28/24

Conservation Commission Site Plan  
in  
Chilmark, Massachusetts  
Assessor Parcel 11-25.1  
prepared for  
**Joan & James E. Hartley**  
Scale 1"=30' March 28, 2024

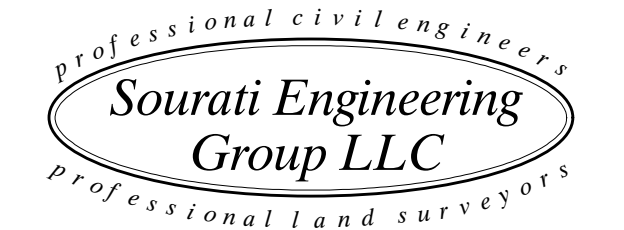

P.O. Box 4458  
107 Beach Road, Suite 202  
Vineyard Haven, MA 02568  
Phone (508) 693-9933 Fax (508) 693-4933

NOTES:  
1. LOT AREA: 8.3+ ACRES.  
2. DATUM: NAVD 1988.  
3. FOR DETAILS AND ADDITIONAL INFORMATION  
REFER TO POOL GARDEN - LANDSCAPE  
MASTERPLAN DATED MARCH 22, 2024, PREPARED BY  
MATTHEW CUNNINGHAM LANDSCAPE DESIGN LLC.

MAP II  
PARCEL 26.1