

MAR 29 2024

S. LARSEN

J. LARSEN

C. FLANDERS

ROW

Town

Denny JASON

Vacant

C. MURPHY

W. JENKINSON

J. MAYHEW

AGUENAH

MENAMSHA INLET (OLD CHANNEL)

COMMONWEALTH LAND

MENAMSHA

CHILMARK - GAY HEAD

DEPARTMENT OF PUBLIC WORKS OF MASSACHUSETTS

DIVISION OF WATERWAYS

APRIL 1939 SCALE 1:500

Francis J. ...

DISTRICT WATERWAYS ENGINEER

CHILMARK

Permit No. 5029 granted
October 2, 1951 by the
Department of Public Works.
Francis J. ...
Secretary.

42G

NORTH COUNTY ROAD

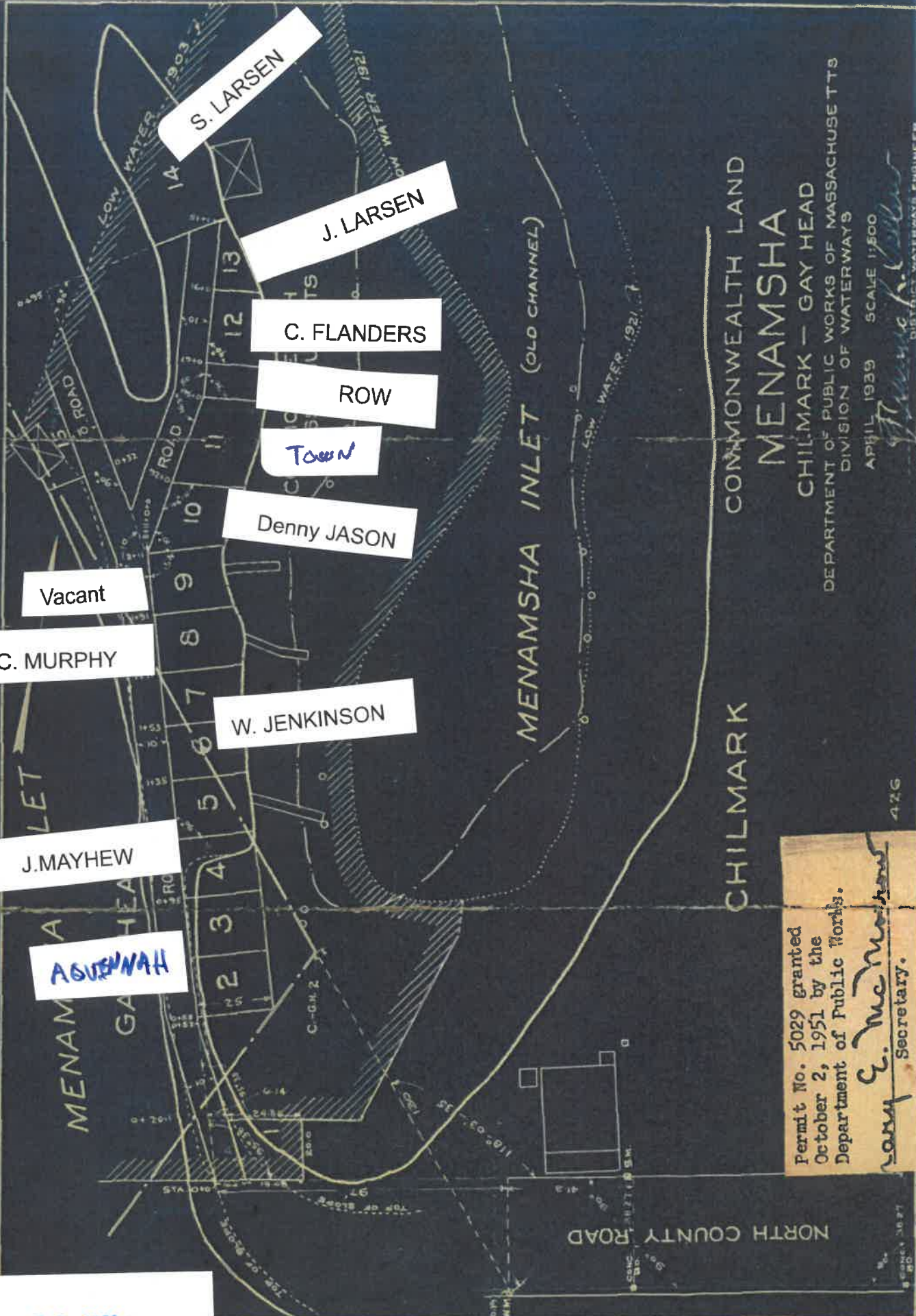

Creek Lots: lot assignments
Contact List with Addresses

Lot 12

Mr. Carl E Flanders
4 Larsen Lane, North Fork
Chilmark, Ma. 02535

Lot 10

Mr. Dennis M. Jason
14 Ridge Hill Road
Chilmark, Ma. 02535

Lot 8

Mr. Chis Murphy
88 Murphy Road
Chilmark, Ma. 02535

Lots 6&7

Mr. Walter A. Jenkinson III
131 North Road
P.O. Box 28
West Tisbury, Ma 02575

Lot 13

Mr. John Larsen
108 Hammett Lane
Chilmark, Ma. 02535

Lot 14

Mr. Stephen Larsen,
Louis Stanley Larsen
13 Wampum Way
Chilmark, Ma. 02535

Lots 4&5

Mr. Jonathan Mayhew
P.O. Box 32
Chilmark. Ma. 02535

*Fish house
Assessor →
add a # to it?
tax steven Z mce*